

Town of Germantown Road Surface Management Plan 2017

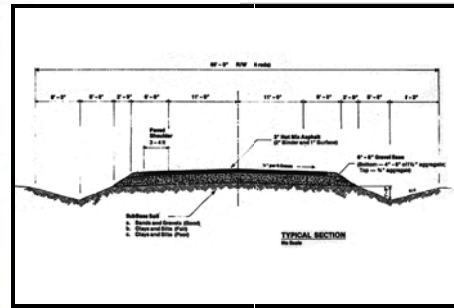

PASER

Pavement Surface Evaluation and Rating

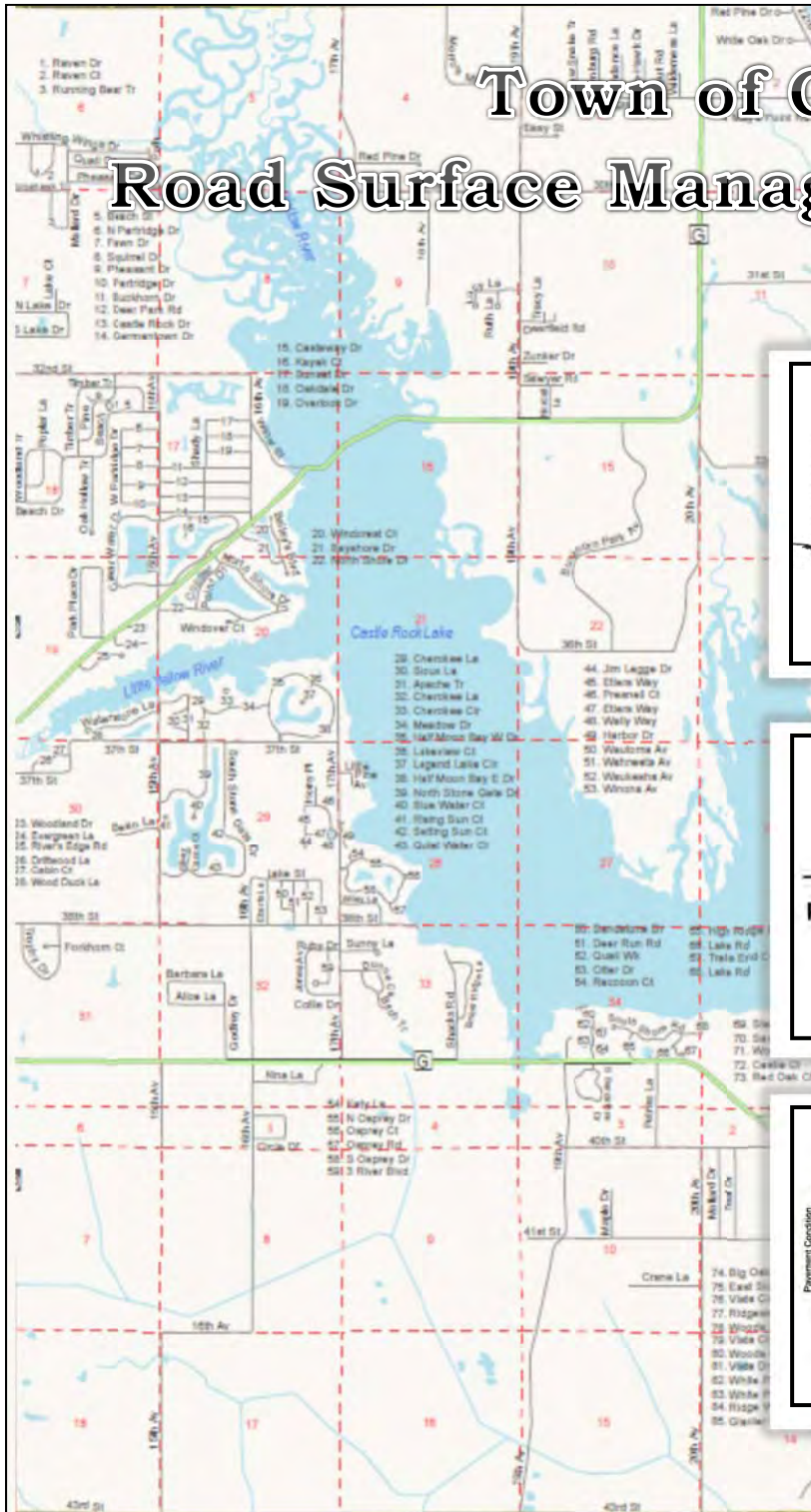
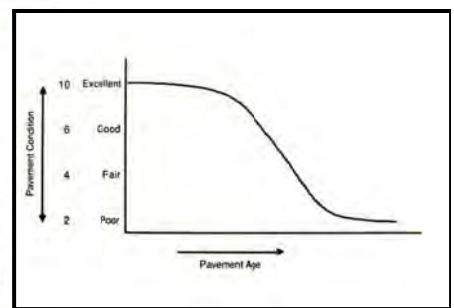

Prepared by:

**North Central Wisconsin
Regional Planning Commission**

Contact: 715-849-5510 / www.ncwrpc.org



**TOWN OF GERMANTOWN, WISCONSIN
ROAD SURFACE MANAGEMENT PLAN**

TABLE OF CONTENTS

	Page
CHAPTER 1 Road Surface Management Plan Overview	3
Introduction	3
Purpose of Road Surface Management Plan.....	3
Intended Road Surface Management Plan Results	4
CHAPTER 2 Town of Germantown’s Existing Roadway System	5
Existing System	5
Functional Classification System	5
CHAPTER 3 Road Surface Management Plan Results.....	7
Pavement Surface Evaluation and Rating	7
Pavement Surface Needs Analysis	8
Project Prioritization	9
CHAPTER 4 Roadway Practices and Recommended Improvements	10
General Maintenance and Improvement Practices	10
Recommended Five Year Roadway Improvement Schedule	12
Recommended State/County Improvement Projects	12
Conclusion	12
 Appendix A WISLR Road Inventory	
 Appendix B PASER Rating System	
 Appendix C Town Road Map	
 Appendix D Additional Projects Outside Budget Allocation	

LIST OF TABLES

	Page
Table 1	Asphalt Surface Rating Condition & Suggested Improvement..... 8
Table 2	Gravel Surface Rating Condition & Suggested Improvement 8

LIST OF FIGURES

Figure 1	Town of Germantown Functional Classification Miles 6
Figure 2	Percent of Paved Roads – By Surface Rating 7
Figure 3	Percent of Unpaved Roads – By Surface Rating 7
Figure 4	Typical Pavement Condition Life Cycle..... 9

CHAPTER 1 ROAD SURFACE MANAGEMENT PLAN OVERVIEW

INTRODUCTION

A road surface management plan for a local road network provides a town with the ability to plan for future road surface improvements. With a road surface management plan in place, the limited resources allocated to local roads can be better spent. The overall goal of the Road Surface Management Plan is to help the town make better decisions on the improvements to the local road system. This document contains information vital to the review and rating of the Town of Germantown's roadway system. Thus, the Road Surface Management Plan will assist in preserving and rehabilitating the existing town road system in a timely and cost-effective manner.

Information necessary to complete the road surface management plan was collected by the North Central Wisconsin Regional Planning Commission (NCWRPC) from pavement surface rating data submitted to DOT by the town in 2015 and from supplemental information on road work undertaken in 2015 and 2016 after the inventory had been submitted.

PURPOSE OF ROAD SURFACE MANAGEMENT PLAN

A Road Surface Management Plan helps local government officials respond to growing pressures from constituents to repair roads and upgrade the quality of roads by providing documented information on suggested priorities for improvement and reliable estimates of current and future costs of maintaining and improving the quality of the local road system.

Road Surface Management Plans help local officials allocate scarce resources, which are caused by some of the following:

1. Negative public attitudes towards higher property taxes;
2. The historic limits on state and federal revenues to local governments to keep pace with increasing costs of providing local services;
3. An increase in road maintenance and construction costs which have outstripped the available public resources;
4. Historic local budget difficulties have resulted in deferred maintenance on local road systems, thus compounding needs for additional local resources; and/or
5. Some local units of government have not used their scarce dollars in a wise manner. Local politics and poor decision-making have, in some cases, resulted in funds being spent in the wrong places or in an inefficient manner.

The objectives for using a pavement management system include:

1. A better understanding of pavement conditions by completing an overall field inventory;
2. An evaluation of causes of pavement conditions by the roadway segments' corresponding rating and analysis of distress;
3. Through improved decision making by taking advantage of preventative maintenance and selection of the most effective repair or rehabilitation;
4. Better communication of needs and strategies to decision makers as a tool to explain needs and convince elected officials and the public that adequate budgets are needed;
5. Long-term planning helps local governments coordinate pavement needs and scheduling with other budget and policy decisions.

INTENDED ROADWAY MANAGEMENT PLAN RESULTS

The results of the Road Surface Management Plan are intended to assist the Town of Germantown in developing a road surface improvement program whereby the limited transportation dollars allocated yearly can be spent more wisely. Through this effort, a better transportation system will be realized over time. A road surface management plan can also assist in vying for additional county, state or federal funding.

CHAPTER II TOWN OF GERMANTOWN'S EXISTING ROADWAY SYSTEM

EXISTING SYSTEM

Prior to the development of a Road Surface Management Plan, an inventory of the existing system must be completed. This inventory will assist in cataloging the roadway characteristics by roadway segment and surface type. The field data collected will be used as a benchmark to establish the prioritization of the existing roadway system and will assist in the development of recommended improvements to the local road system.

The Wisconsin Department of Transportation (WisDOT) maintains a roadway characteristic inventory on all local roads eligible to receive state funding through the transportation aids program, see Appendix A. This data file is used as the basis for beginning the Road Surface Management Plan. From the base data already collected by the state, a review of the road system may note changes in the roadway characteristics. Thus, this information is updated and represented as such in the data sheets found in the back of this document. The state's inventory of the roadway system includes such features as:

1. Segment length;
2. Surface type (i.e. earth, gravel, asphalt, or concrete);
3. Functional classification; and
4. Surface and shoulder width.

The review of the town road system was completed by town officials following the Wisconsin DOT Plat Record Maps and corresponding data provided by WisDOT for each roadway segment.

FUNCTIONAL CLASSIFICATION SYSTEM

Town of Germantown's roads perform varied functions from moving goods and people within the community or through the community. These roads differ from one-another and are characterized by a functional classification system. In the development of this Road Surface Management Plan, the functional classification of the roads is described as follows:

Arterials: Arterials provide service to moderate sized communities and other intra-area traffic generators (schools, churches, employment or service centers) and link those generators to nearby larger population concentrations or major federal or state highways.

Collectors: Collectors provide service to remaining population concentrations not served by higher classified routes, link the locally important traffic generators (schools, churches, and employment and service centers) with the rural hinterland, and are spaced consistent with population density so as to collect traffic from local roads and bring developed areas within a reasonable distance of a higher classified road.

Local Roads: Local roads provide access to adjacent land and provide for travel over relatively short distances. All roads not classified as arterials or collectors will be local functional roads.

The functional classification mileage of the town system is depicted in Figure 1.

FIGURE 1

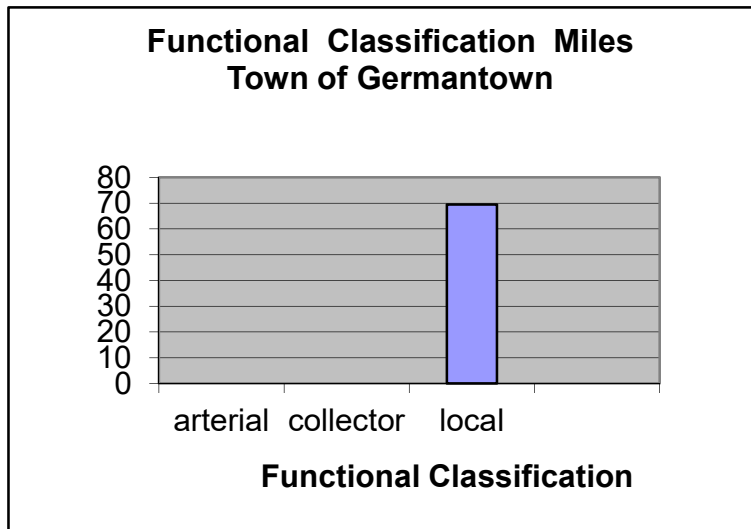

By way of comparison, most county highways are in the collector category, and most state trunk and federal routes are arterials. The classification of roads indicates a number of factors regarding the nature of the road for roadway management such as:

1. Role the road plays in providing mobility (through traffic) as opposed to providing access to adjoining property.
2. Amount of development adjacent to a roadway. The more adjoining development, the higher the classification. The nature of the development must also be considered here. In the case of development that would serve a high number of trips, such as commercial, industrial, or institutional a road could be considered for a higher classification.
3. The average daily traffic on the road. Generally, the higher the traffic the higher the classification.

CHAPTER III ROADWAY MANAGEMENT PLAN RESULTS

PAVEMENT SURFACE EVALUATION AND RATING

The data reported in this Road Surface Management Plan was produced using the Pavement Analysis Tool within the Wisconsin Information System for Local Roads (WISLR). Critical to the development of the surface condition rating of each roadway segment, was a uniform and consistent set of criteria used in evaluating and assigning a value to each roadway segment. To achieve this consistent evaluation, the Pavement Surface Evaluation and Rating (PASER) system developed by the University of Wisconsin - Madison, Transportation Information Center was utilized, see Appendix B. The consistency in evaluating each roadway segment is critical since this information will lead to the development of future improvements needed to the local system.

Based upon the WISLR data collected, there are 69.52 miles of road on the town's system. On this system, about 63 percent are paved and 37 percent are unpaved surfaces. FIGURE 2 depicts the surface condition ratings of the town's paved roads, and FIGURE 3 shows the unpaved.

FIGURE 2

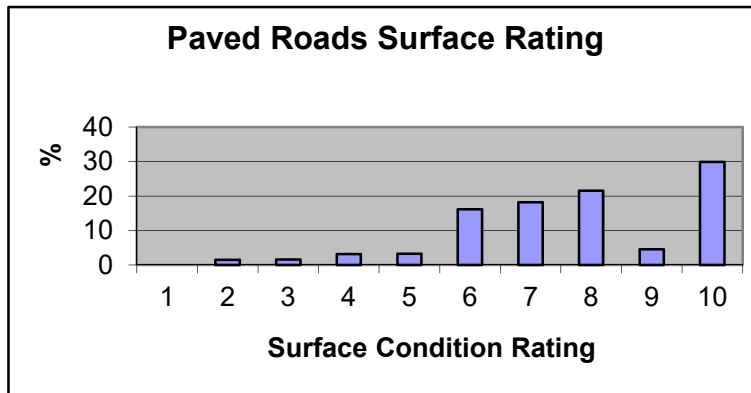
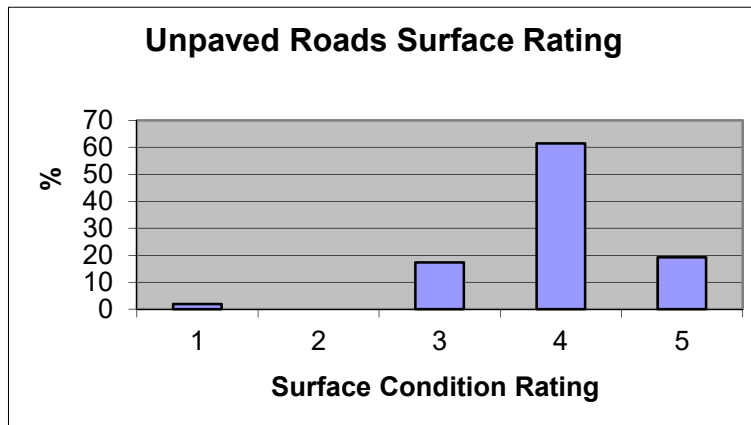

FIGURE 3



These ratings indicate that the system is in relatively sound condition and not in need of any immediate structural improvements. For paved roads, over 47 percent (about 33 miles) of the system is currently in need of no maintenance, while just over 18 percent (about 13 miles) of the system currently is in need of only minor, routine maintenance. However, about 13.4 miles (19.5 %) of the system could benefit from a preservative treatment such as a sealcoat to extend pavement life. Only about 4.4 miles (6.3 %) are candidates for structural improvement (reconstruction or overlay). For unpaved roads, the vast majority, 80 percent, needs only routine maintenance.

PAVEMENT SURFACE NEEDS ANALYSIS

Pavement management is a systematic process that uses roadway data to facilitate development of cost-effective maintenance and improvement programs. The WISLR Pavement Analysis Tool takes a “value-based” approach to pavement management. The objective of this approach is to get more value (cost-effectiveness) from improvement expenditures by getting more pavement life at a lower cost and improving ride quality.

Accomplishing this objective requires selecting the right projects and applying the right fix at the right time.

The surface condition rating value and corresponding suggested improvements for asphalt (paved) roads are represented in TABLE 1 and gravel (unpaved) in TABLE 2.

TABLE 1 ASPHALT SURFACE RATING CONDITION & SUGGESTED IMPROVEMENT	
RATING	ACTION REQUIRED
10 – 9	No Maintenance Required
8	Little or No Maintenance Required
7	Crack Filling
6 - 5	Preservative Treatment (sealcoat)
4 – 3	Structural Improvement (overlay or recycling)
2 - 1	Reconstruction

TABLE 2 GRAVEL SURFACE RATING CONDITION & SUGGESTED IMPROVEMENT	
RATING	ACTION REQUIRED
5 – 4	Routine Maintenance
3	Minor Ditching/Add Gravel
2	Add Gravel/Drainage Improvement
1	Reconstruction

PROJECT PRIORITIZATION

WISLR prioritization emphasizes treating pavements in the “region of opportunity” (see Figure 4) because pavements in this condition range can typically be maintained at a much lower cost per year of service life extension. However, the WISLR model also places priority on roadway classification, recognizing that the most important roads in poor to failed condition can't be ignored. The combined effect of this dual-priority approach is intended to select projects based on both cost-effectiveness and importance to overall system function.

FIGURE 4

Typical Pavement Condition Life Cycle

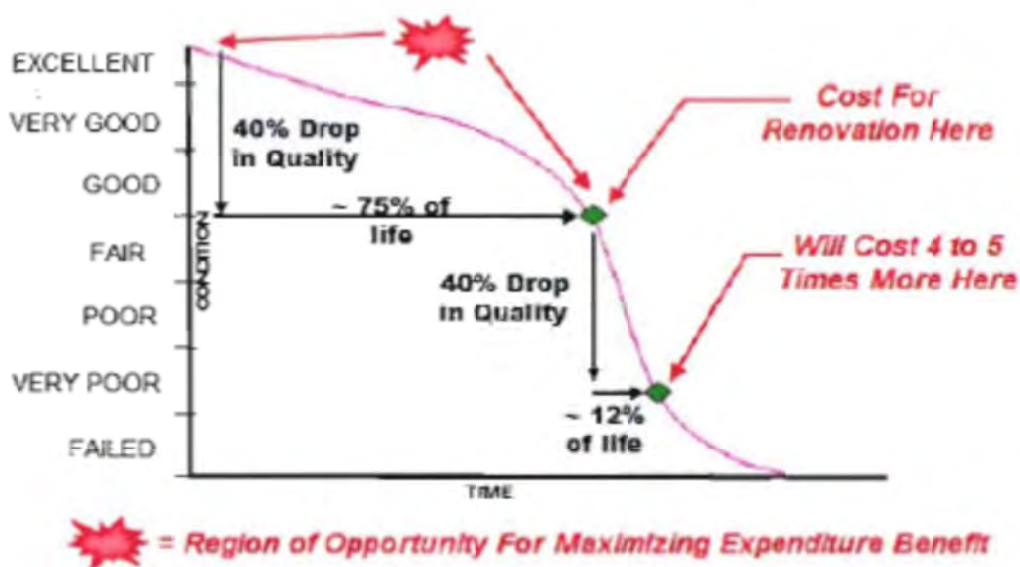

Source: WisDOT

This approach provides a reasonable starting point for programming within a constrained budget. Ultimately project selection will need to incorporate other important factors not included in the WISLR data such as safety, utilities, roughness, etc.

The intent of the WISLR pavement analysis tool is to provide abundant pavement condition and budget impact information in order to aid in project selection and in order to help substantiate budget levels.

CHAPTER IV ROADWAY PRACTICES AND RECOMMENDED IMPROVEMENTS

GENERAL MAINTENANCE AND IMPROVEMENT PRACTICES

The maintenance and improvement of local roads is critical to having a sustainable roadway system. Building good roads result in longer lasting roads.

Building good roads is basic to having a local roadway system that will carry vehicles safely and efficiently, and that save money by lowering future improvement costs. What are some of the basic concepts of building good roads that will last? Below is a list of ten basic concepts to follow when building roads.

1. Get water away from the road. Good drainage is critical to making a good road. It has been estimated that nearly 90% of a road's problems can be attributed to excess water or to poor water drainage. Effective drainage systems divert, drain, and dispose of water along a roadway. These drainage systems use interceptor ditches and slopes, roadway crowns, and ditch and culvert systems. Interceptor ditches, located between the road and higher ground, divert the water by sloping away from the road so that the water does not reach the roadway. Crowning a roadway assists in moving water off the roadway to the interceptor ditch. Typically, a gravel roadway crown should be ½" higher than the shoulder for each foot of width from the centerline to the edge. A paved road crown should be ¼" higher than the shoulder for each foot of width from the centerline to the edge. Too much water remaining on a roadway surface, or in the subbase and subgrade combine with the action of traffic to create potholes, cracks, and pavement failure. Ditches and culverts dispose of water by carrying it away from the road structure. Ditches should be one foot lower than the base of the road. Improper drainage can allow water to seep under the roadway creating the potential for future roadway failures. A rule of thumb is that one-dollar spent on proper roadway drainage will save two dollars on maintenance.
2. Building a firm foundation. A roads foundation is important to the life of your road. A road wears out from the top down but falls apart from the bottom. The subgrade and subbase layer of a road support the entire roadway and traffic using it.
3. Use the best material. When it comes to using materials in the construction or improvement of a road, you will either "pay for it now or later." The selection of materials for the project will determine how long a road may last. Inferior materials may cause premature improvements or life long maintenance to the road. Crushed aggregate is the best material for a base course as the sharp edges interlock when compacted. Rounded aggregate is a poor base course as they will move under the weight of traffic.
4. Compact all layers. Generally, the more densely a material is compacted, the stronger it is. The compaction also helps prevent water moving in and throughout the

subbase layer of the roadway. This helps prevent frost heaving and premature deterioration of the roadway. Using gravel with a mix of sizes (well-graded aggregate) allows smaller particles to fill-in the voids created by larger particles.

5. Design for traffic loads and volumes. A road should be designed to carry the highest anticipated load. If this load is unknown, the road should be designed to carry the largest maintenance equipment that will be used on the road. A well-constructed and maintained asphalt road should last 20 years without major repairs or reconstruction. One truck with 9 tons on a single rear axle does as much damage to a road as nearly 10,000 cars!

6. Design for maintenance. Design your road so that it may be easily maintained by having adequate ditches that can be cleaned regularly, culverts that are marked for future maintenance activities, an area where snow can be plowed onto, proper slopes of the roadway and ditches, ditches that are planted to prevent erosion, and ditches that can be mowed safely.

7. Pave only when ready. Every road does not have to be an asphalt road. Laying asphalt on an existing roadway will not fix a gravel road that is failing. Adequate crushed aggregate, drainage, and proper compaction must be in place to support the longevity of an asphalt road. Depending on the subgrade soils of any road, a recommended minimum subbase depth of crushed stone is 10”.

8. Build from the bottom up. Do not waste material on a top dress or resurface if the problem is actually a subbase or subgrade problem. This method does not correct the problem and will result in unwisely spent funds. Choosing an improvement technique that gets to the root of the problem will be the only thing that makes the roadway better.

9. Protect your investment. The local road system often is the Community’s largest investment. These maintenance activities are critical to the longevity of a local road:

Surface Grade, shape, patch, seal crack, control dust, remove ice and snow;

Drainage Clean and repair ditches and culverts, remove excess debris;

Roadside Cut brush, trim trees and roadside plantings, control erosion; and

Traffic Service Clean and repair or replace signs.

10. Keep good records. Knowing each road’s construction, life, and repair history makes it easier to plan and budget for future improvements.

The ten basic concepts discussed above will assist in providing a good roadway system that will be more popular with the local citizens and will likely assist in making the transportation improvement budget cover more miles of road in a given year.

RECOMMENDED FIVE-YEAR IMPROVEMENT SCHEDULE

The five-year pavement rehabilitation schedule shown on the following pages is based on input from town officials and the town's reported budget of \$110,000 per year and was derived using the WISLR Pavement Analysis Tool as explained earlier in this report. This pavement analysis suggested several projects that were not able to be accommodated within the budgeted amount. These possible projects are identified in Appendix D for consideration if additional funds (e.g. a successful grant application) become available in a given year or if scheduled projects are not able to be completed for whatever reasons.

The costs for each project listed may differ from the final project costs. An engineering report is required for projects to be eligible for State LRIP funding. That report would identify the final project costs for a project grant application.

RECOMMENDED STATE/COUNTY IMPROVEMENT PROJECTS

Although this road surface management report primarily applies to the local roads under the jurisdiction of the town, there are roads under the jurisdiction of the state and county that play an important role in the road network that serves the town. As such, this plan encourages and supports the recommended safety improvements for the intersection of County Highway G and State Truck Highway 58:

- CTH G and STH 58 (South Jct) Intersection - Proposed offset right turn lane and intersection upgrade.

The Town of Germantown is a growing tourist destination and booming vacation home market with 100's of new lots being proposed. Traffic levels in the area can only be expected to increase. STH 58 and CTH G are the only arterial / collector roadways serving the Town of Germantown.

Currently, dangerous conditions exist at this intersection, south junction - CTH G and STH 58, that are resulting in significant accidents. The existing intersection has a right turn lane on STH 58 which has enough volume to block vision for stopped vehicles on CTH G. The proposed project will provide an offset right turn lane so that vision to the south (left) will not be blocked for vehicles stopped on CTH G.

CONCLUSION

This plan should serve as the road surface improvement budget plan for the Town of Germantown. However, the Town Board may shift projects from year to year as conditions warrant. It is important that the inventory of the pavement surface conditions be updated every two years, so that the priorities list may be kept current. Likewise, cost estimates can be revisited as the actual costs of road improvements change from year to year. Updating information on a regular basis is important to the long-range success of this program plan.

**TOWN OF GERMANTOWN
PAVEMENT REHABILITATION SCHEDULE
YEAR ONE**

All measurements in feet.

On Route	At Route	To		Width	Surf. Type	Pvmt Rtg					Priority Score
		At	Offset			Offset	Length	Yr 1	Yr 5	Action	
19th Ave	CTH G	0	30th St E	6653	18 55	4/6	7	Single Sealcoat	\$11,177	39.92	
Nordall Ln	Sawyer Rd	0	CTH G	1056	22 40	3	4	Sealcoat	\$2,168	39.92	
Sawyer Rd	19th Ave	0	Termini	1320	20 40	3	4	Sealcoat	\$2,463	39.92	
28th St E	17th St	0	19th Ave	5280	18 55	2		Sealcoat	\$8,870		
"Castle Rock Estates"											
37th St E	STH 58 / 37th St E	0	17th Ave	10666	20 50	7	7/10	Dig Out Dips	\$10,000	49.9	
				2000				Relocation Project*	\$60,969		
				8666				Crack Sealing	\$7,893		
15th Ave	N Stone Gate Dr	0	38th St	3572	20 55	7	7	Crack Sealing	\$3,254	49.9	
Lake Rd	South Shore Rd	0	CTH G / Petras Ln	1109	20 70	7	7	Crack Sealing	\$1,010	49.9	
Lake Rd	Termini	0	South Shore Rd	792	10 70	7	7	Crack Sealing	\$360	49.9	
Red Oak Ct	Evergreen St	0	Termini	158	22 50	8	7	Crack Sealing	\$158	49.9	
Red Pine Dr	22nd Ave	0	Termini	792	20 70	8	7	Crack Sealing	\$721	49.9	
Ruth Ct	Lucey Ln	0	Termini	475	20 40	4	4	Sealcoat	\$957	39.92	
									<u>\$110,000</u>		

*LRIP PROJECT - Match Budget Shown.

**TOWN OF GERMANTOWN
PAVEMENT REHABILITATION SCHEDULE
YEAR TWO**

All measurements in feet.

On Route	At Route	At		Offset	Length	Width	Surf. Type	Pvmt Rtg		Cost	Priority Score
		Toward	To					Yr 1	Yr 5		
J Zilinski Ln	40th St E / CTH G / Evergreen St	0	41st St	2640	2640	12	45	6	7	\$ 3,121	39.92
Petras Ln	CTH G / Lake Rd	0	40th St E	2482	2482	20	55	5	6	\$ 11,404	33.27
N Lake Dr	STH 58	0	Mallard Dr	1689	1689	20	35	4	8	\$ 36,989	
Lake Ct	Termini	0	N Lake Dr	370	370	12	35	4	8	\$ 8,160	
Mallard Dr	N Lake Dr	0	S Lake Dr	686	686	20	35	4	8	\$ 15,023	
S Lake Dr	Mallard Dr	0	STH 58	1690	1690	20	35	4	8	\$ 37,011	
										<u>\$ 111,708</u>	

**TOWN OF GERMANTOWN
PAVEMENT REHABILITATION SCHEDULE
YEAR THREE**

All measurements in feet.

On Route	At Route	At	Offset	Toward	Route	To	Surf.	Width	Type	Yr 1	Yr 5	Action	Cost	Priority	
														Score	Score
16th Ave	38th St	0	3960	CTH G	3960	20	50	8	Sealcoat	8	8	Sealcoat	\$7,982	49.9	
16th Ave	CTH G	0	3274	"Swamp Road"	3274	20	55	3	Sealcoat			Sealcoat	\$6,600	24.95	
"Castle Rock Estates"													\$10,000		
17th Ave	CTH G		10560	Termini		20	70	6	8	8	Reconstruct/Widen*	\$85,418	39.92		
													<u>\$110,000</u>		

*Specific project details currently under development.
Anticipate submission of LRIP Grant Application.
Match budget shown.

**TOWN OF GERMANTOWN
PAVEMENT REHABILITATION SCHEDULE
YEAR FOUR**

All measurements in feet.

On Route	At Route	At	Offset	Toward	Route	To	Offset	Length	Width	Surf. Yr	Pvmt Rtg Yr	Action	Cost	Priority Score
30th St E	17th St	0	18th St	2165	2165	22	40	3	4	Sealcoat		\$4,935	39.92	
17th St	28th St E / 17th Ave	0	30th St E	5438	5438	22	40	4	4	Sealcoat		\$11,986	39.92	
19th Ave	40th St E	0	CTH G	2534	2534	22	40	4	4	Sealcoat		\$5,776		
Whistling Wings Dr	STH 58	0	Deer Path	4172	4172	20	40	4	4	Sealcoat		\$8,409		
Raven Dr	Whistling Wings Dr	0	Whistling Wings Dr	2165	2165	20	40	4	4	Sealcoat		\$4,364		
Raven Ct	Raven Dr	0	Termini	370	370	20	57	7	7	Sealcoat		\$745	49.9	
Mallard Dr	Whistling Wings Dr	0	Tomahawk Trl	1056	1056	20	40	4	4	Sealcoat		\$2,128		
Mallard Dr	Tomahawk Trl	0	Termini	1320	1320	10	40	4	4	Sealcoat		\$2,660		
Deer Path	Termini	0	Termini	1266	1266	20	40	5	5	Sealcoat		\$2,551		
Quail Dr	Mallard Dr	0	Deer Path	2376	2376	20	40	4	4	Sealcoat		\$4,789		
Pheasant Dr	Mallard Dr	0	Deer Path	2165	2165	20	40	4	4	Sealcoat		\$4,364		
Running Bear Trl	Tomahawk Trl	0	Mallard Dr	1478	1478	10	40	4	4	Sealcoat		\$1,602	39.92	
Tomahawk Trl	Mallard Dr	0	STH 58 / 30th St W	1689	1689	20	40	4	4	Sealcoat		\$3,404		
"Castle Rock Estates"										Dig Out Dips		\$10,000		
Legend Lake Cir	Termini	0	Half Moon Bay Dr EW	792	792	24	55	7	7	Crack Sealing		\$865	49.9	
Meadow Ct	Meadow Dr	0	Termini	792	792	22	55	7	7	Crack Sealing		\$793	49.9	
Meadow Dr	Cherokee Ln	0	Meadow Ct	845	845	22	70	7	7	Crack Sealing		\$846	49.9	
N Osprey Dr	17th Ave	0	Osprey Ct	2059	2059	22	57	7	7	Crack Sealing		\$2,063	49.9	
N Osprey Dr	Osprey Ct	0	S Osprey Dr / Rd	845	845	22	57	7	7	Crack Sealing		\$846	49.9	
N Osprey Dr	Osprey Ct	0	Osprey Ct	158	158	22	57	7	7	Crack Sealing		\$158	49.9	
Osprey Ct	N Osprey Dr	0	N Osprey Dr	370	370	22	57	7	7	Crack Sealing		\$370	49.9	
Osprey Rd	N Osprey Dr/S Osprey Dr	0	Termini	264	264	22	57	7	7	Crack Sealing		\$264	49.9	
Ridgewater Dr	CTH G	0	Termini	1426	1426	22	70	7	7	Crack Sealing		\$1,428	49.9	
S Osprey Dr	N Osprey Dr	0	N Osprey Dr / Rd	2059	2059	22	57	7	7	Crack Sealing		\$2,063	49.9	
White Oak Dr	22nd Ave	0	Termini	845	845	20	70	7	7	Crack Sealing		\$769	49.9	
32nd St E	32nd St W / STH 58	0	16th Ave	6969	6969	20	55	7	7	Crack Sealing		\$6,349	49.9	
15th Ave	CTH G / 16th Ave	10349	43rd St / 15th Ave	13147	2798	18	50	5	6	Sealcoat+Patching		\$11,763	33.27	
15th Ave	CTH G	0	Termini	2482	2482	20	50	5	6	Sealcoat+Patching		\$11,250	33.27	
30th St E	Termini	0	17th St	422	422	16	40	3	4	Sealcoat		\$693	39.92	
Forkhorn Ct	Trophy Dr	0	Termini	634	634	20	40	3	4	Sealcoat		\$1,278	39.92	
Oakwood Ln	CTH G	0	Evergreen Ln	317	317	18	40	3	4	Sealcoat		\$532	39.92	
													<u>\$110,043</u>	

**TOWN OF GERMANTOWN
PAVEMENT REHABILITATION SCHEDULE
YEAR FIVE**

All measurements in feet.

On Route	At Route	At	To	Offset	Length	Width	Surf. Type	Pvmt Rtg			Action	Cost	Priority Score
								Yr 1	Yr 5	Yr 10			
Sandstone Dr	CTH G	0	Termini	3062	3062	20	40	3	10	Reconstruct	\$67,096	39.92	
19th Ave	43rd St/43rd St W/16th Ave(1)	0	41st St	8184	8184	22	40	4	4	Sealcoat	\$17,422	39.92	
19th Ave	30th St E		29th St	8184	5438	18	55	6	8	Sealcoat	\$9,315		
29th St E	CTH G	0	Termini	6917	6917	24	55	8	7	Crack Sealing	\$7,562	49.9	
43rd St W	15th Ave / 43rd St	3115	43rd St	10560	7445	24	55	8	7	Crack Sealing	\$8,139	49.9	
Rising Sun Ct	15th Ave / Bean Ln	0	Termini	535	535	20	70	8	7	Crack Sealing	\$487	49.9	
											<u>\$110,021</u>		

Note: Push 38th St project to 2022 or a future year when necessary funding levels and grants can be applied within budget.

APPENDIX A - WISLR Road Inventory

STATE OF WISCONSIN
DEPARTMENT OF TRANSPORTATION
WISCONSIN INFORMATION SYSTEM FOR LOCAL ROADS

Inventory Listing With Maintenance (R-20)
1-1-2017 Certification

TOWN OF GERMANTOWN (012)

Rd/St Name		Certified Miles																											
15th Ave		4.25																											
AT RD/ST OFFSET MILES	TO ROAD NAME OFFSET MILES	LENGTH MILES (FEET)	OW L	SURFACE		MAINT		CURB SHOULDER		MEDIAN		ADT		ROW		FC	RC	SC	O	U/A	NHS	H	AC	ALN	INV	PVT	SW		
				Type	WD	YR	Type	YR	LT	RT	LT	RT	Type	WD	I	CNT	YR	I	W					H	V	YR	R	YR	
32nd St E	Beach Dr	0.21 (1109)	N 2	40	22	2006	2	2012	3	0	0	202	202	0	0	E	000015		E	66	45	5					2016	4	2015
Beach Dr	Castaway Dr	0.61 (3197)	N 2	40	24	2006	2	2012	3	0	0	202	202	0	0	E	000015		E	66	45	5					2016	4	2015
Castaway Dr	Castaway Dr	0.36 (1906)	N 2	40	24	2006	2	2012	3	0	0	202	202	0	0	E	000015		E	66	45	5					2016	4	2015
Castaway Dr	CTH G	0.08 (441)	N 2	40	24	2006	2	2012	3	0	0	202	202	0	0	E	000015		E	66	45	5					2016	4	2015
CTH G	North Shore Dr	0.04 (225)	N 2	40	20	1973	2	2012	4	0	0	104	104			E	000050		E	66	45	5					2016	4	2015
North Shore Dr	Termini	0.23 (1201)	N 2	40	20	1973	2	2012	4	0	0	104	104			E	000050		E	66	45	5					2016	4	2015
Termini	Cherokee Ln	0.04 (211)	N 2	40	20	1976	2	2012	4	0	0	102	102			E	000015		E	66	45	5					2016	4	2015
Cherokee Ln	Waterstone Ln	0.05 (252)	N 2	40	20	1976	2	2012	4	0	0	102	102			E	000015		E	66	45	5					2016	4	2015
Waterstone Ln	37th St E	0.15 (804)	N 2	40	20	1976	2	2012	4	0	0	102	102			E	000015		E	66	45	5					2016	4	2015
37th St E	N Stone Gate Dr	0.33 (1760)	N 2	55	20	1970	2	2012	4	0	0	102	102			E	000015		E	66	45	5					2016	8	2015
N Stone Gate Dr	Bean Ln	0.15 (774)	N 2	55	20	1970	2	2012	4	0	0	102	102			E	000015		E	66	45	5					2016	7	2015
Bean Ln	S Stone Gate Dr	0.25 (1322)	N 2	55	20	1970	2	2012	4	0	0	102	102			E	000015		E	66	45	5					2016	7	2015
S Stone Gate Dr	38th St	0.28 (1476)	N 2	55	20	1970	2	2012	4	0	0	102	102			E	000015		E	66	45	5					2016	7	2015
CTH G	Termini	0.47 (2482)	N 2	50	20	1999	2	2012	4	0	0	000	000			E	000005		E	66	45	5					2016	5	2015
16th Ave (1.96)	43rd St (2.49)	0.53 (2798)	N 2	50	18	1970	2	2012	4	0	0	102	102			E	000015		E	66	45	5					2016	5	2015
16th Ave (2.49)	43rd St	0.46 (2429)	N 2	40	20	2002	2	2012	4	0	0	102	102			E	000015		E	66	45	5					2016	5	2015

STATE OF WISCONSIN
 DEPARTMENT OF TRANSPORTATION
 WISCONSIN INFORMATION SYSTEM FOR LOCAL ROADS
 Inventory Listing With Maintenance (R-20)
 1-1-2017 Certification

TOWN OF GERMANTOWN (012)

Certified Miles

16th Ave		3.52																										
AT RD/ST OFFSET MILES	TO ROAD NAME OFFSET MILES	LENGTH MILES (FEET)	OW L	SURFACE		MAINT	P	CURB SHOULDER		MEDIAN		ADT		ROW		FC	RC	SC	O	U/A	NHS	H	AC	ALN H V	INV YR	PVT		SW
				Type	WD			YR	LT	RT	RT	LT	Type	WD	I											CNT	YR	
32nd St E	Water St	0.26 (1373)	N 2	40	24	2006	3	0	0	202	202	0	E	000035	E	66	45	5	4	000	NON	00			2016	5	2015	
Water St	CTH G	0.55 (2904)	N 2	40	24	2006	3	0	0	202	202	0	E	000035	E	66	45	5	4	000	NON	00			2016	5	2015	
38th St	CTH G	0.75 (3960)	N 2	50	20	2003	4	0	0	202	202		E	000015	E	66	45	5	4	000	NON	00			2016	8	2015	
CTH G	15th Ave (0.62)	0.62 (3274)	N 2	55	20	2002	4	0	0	102	102		E	000015	E	66	45	5	4	000	NON	00			2016	3	2015	
CTH G (0.62)	15th Ave (1.96)	1.34 (7075)	N 2	35	18	1970	4	0	0	102	102		E	000015	E	66	45	5	4	000	NON	00			2016	3	2015	

17th Ave

17th Ave		2.00																											
AT RD/ST OFFSET MILES	TO ROAD NAME OFFSET MILES	LENGTH MILES (FEET)	OW L	SURFACE		MAINT		P	CURB SHOULDER		MEDIAN		ADT		ROW		FC	RC	SC	O	U/A	NHS	H	AC	ALN H V	INV YR	PVT		SW
				Type	WD	YR	Type		YR	LT	RT	RT	LT	Type	WD	I											CNT	YR	
Termini	37th St E	0.25 (1320)	N 2	55	22	1999	2	2012	4	0	0	102	102	E	000015	E	66	45	5	4	000	NON	00			2016	6	2015	
37th St E	Haagenson Cir	0.50 (2640)	N 2	50	20	2006	3	0	0	102	102	0	E	000035	E	66	45	5	4	000	NON	00			2016	6	2015		
Haagenson Cir	N Osprey Dr	0.19 (1003)	N 2	50	20	2006	3	0	0	102	102	0	E	000035	E	66	45	5	4	000	NON	00			2016	6	2015		
N Osprey Dr	38th St	0.31 (1637)	N 2	50	20	2006	3	0	0	102	102	0	E	000035	E	66	45	5	4	000	NON	00			2016	6	2015		
38th St	Ruby Dr	0.13 (686)	N 2	70	20	2004	4	0	0	201	201		E	000035	E	66	45	5	4	000	NON	00			2016	6	2015		
Ruby Dr	Collie Dr	0.25 (1320)	N 2	70	20	2004	4	0	0	201	201		E	000035	E	66	45	5	4	000	NON	00			2016	6	2015		
Collie Dr	CTH G	0.37 (1954)	N 2	70	20	2004	4	0	0	201	201		E	000035	E	66	45	5	4	000	NON	00			2016	6	2015		

17th St

17th St		1.03																											
AT RD/ST OFFSET MILES	TO ROAD NAME OFFSET MILES	LENGTH MILES (FEET)	OW L	SURFACE		MAINT		P	CURB SHOULDER		MEDIAN		ADT		ROW		FC	RC	SC	O	U/A	NHS	H	AC	ALN H V	INV YR	PVT		SW
				Type	WD	YR	Type		YR	LT	RT	RT	LT	Type	WD	I											CNT	YR	
28th St E	30th St E	1.03 (5438)	N 2	40	22	2009	4	0	0	102	102		E	000015	E	66	45	5	4	000	NON	00			2016	4	2015		

STATE OF WISCONSIN
 DEPARTMENT OF TRANSPORTATION
 WISCONSIN INFORMATION SYSTEM FOR LOCAL ROADS
 Inventory Listing With Maintenance (R-20)
 1-1-2017 Certification

TOWN OF GERMANTOWN (012)

Certified Miles

18th St		0.61																											
AT RD/ST OFFSET MILES	TO ROAD NAME OFFSET MILES	LENGTH MILES (FEET)	OW' L	SURFACE		MAINT	P	CURB		SHOULDER		MEDIAN	ADT		ROW		FC	RC	SC	O	U/A	NHS	H	AC	ALN	INV	PVT		SW
				Type	WD			YR	LT	RT	LT		RT	I	CNT	YR											I	W	
30th St E	Termini	0.61 (3221)	N	2	35	16	1970	4	0	0	102	102	E	000015	E	50	45	5	4	000	NON	00	00	2016	1	2015			

19th Ave		4.83																											
AT RD/ST OFFSET MILES	TO ROAD NAME OFFSET MILES	LENGTH MILES (FEET)	OW' L	SURFACE		MAINT	P	CURB		SHOULDER		MEDIAN	ADT		ROW		FC	RC	SC	O	U/A	NHS	H	AC	ALN	INV	PVT		SW
				Type	WD			YR	LT	RT	LT		RT	I	CNT	YR											I	W	
43rd St W	41st St (0.36)	0.36 (1901)	N	2	40	22	2014	4	0	0	201	201	E	000005	E	66	45	5	4	000	NON	00	00	2016	4	2015			
43rd St W (0.36)	41st St	1.18 (6230)	N	2	40	22	2014	4	0	0	201	201	E	000075	E	66	45	5	4	000	NON	00	00	2016	4	2015			
41st St	41st St	0.01 (53)	N	2	40	22	2014	4	0	0	201	201	E	000035	E	50	45	5	4	000	NON	00	00	2016	4	2015			
41st St	40th St E	0.51 (2693)	N	2	55	18	1970	4	0	0	201	201	E	000035	E	50	45	5	4	000	NON	00	00	2016	4	2015			
40th St E	CTH G	0.48 (2534)	N	2	40	22	1970	4	0	0	201	201	E	000015	E	33	45	5	4	000	NON	00	00	2016	4	2015			
CTH G	Sawyer Rd	0.20 (1056)	N	2	55	18	2002	3	0	0	000	000	E	000075	E	66	45	5	4	000	NON	00	00	2016	4	2015			
Sawyer Rd	Lucey Ln	0.52 (2746)	N	2	55	18	2002	3	0	0	000	000	E	000075	E	66	45	5	4	000	NON	00	00	2016	6	2015			
Lucey Ln	30th St E	0.54 (2851)	N	2	55	18	2002	3	0	0	000	000	E	000075	E	66	45	5	4	000	NON	00	00	2016	6	2015			
30th St E	28th St	1.03 (5438)	N	2	55	18	2002	7	2013	3	0	000	000	E	000075	E	66	45	5	4	000	NON	00	00	2016	6	2015		

20th Ave S		2.01																											
AT RD/ST OFFSET MILES	TO ROAD NAME OFFSET MILES	LENGTH MILES (FEET)	OW' L	SURFACE		MAINT	P	CURB		SHOULDER		MEDIAN	ADT		ROW		FC	RC	SC	O	U/A	NHS	H	AC	ALN	INV	PVT		SW
				Type	WD			YR	LT	RT	LT		RT	I	CNT	YR											I	W	
40th St E	41st St	0.50 (2640)	N	2	50	20	2003	3	0	0	201	201	E	000015	E	66	45	5	4	000	NON	00	00	2016	6	2015			
41st St	43rd St W	1.51 (7973)	N	2	50	20	2002	3	0	0	000	000	E	000015	E	66	45	5	4	000	NON	00	00	2016	6	2015			

STATE OF WISCONSIN
 DEPARTMENT OF TRANSPORTATION
 WISCONSIN INFORMATION SYSTEM FOR LOCAL ROADS
 Inventory Listing With Maintenance (R-20)
 1-1-2017 Certification

TOWN OF GERMANTOWN (012)

Certified Miles

22nd Ave		1.66																												
AT RD/ST OFFSET MILES	TO ROAD NAME OFFSET MILES	LENGTH MILES (FEET)	OW L	SURFACE		MAINT		P	CURB SHOULDER		MEDIAN		ADT		ROW	FC	RC	SC	O	U/A	NHS	H	AC	ALN		INV	PVT		SW	
				Type	WD	YR	Type		YR	LT	RT	LT	RT	Type										WD	I		CNT	YR		I
Mays Ct (0.44)	Red Pine Dr	0.05 (280)	N 2	70	20	2001		4	0	0	101	101		E	000035		66	45	5	4	000	NON		00			2016	8	2015	
Red Pine Dr	White Oak Dr	0.18 (924)	N 2	70	20	2001		4	0	0	101	101		E	000035		66	45	5	4	000	NON		00			2016	8	2015	
White Oak Dr	May's Point Rd	0.28 (1452)	N 2	70	20	2001		4	0	0	101	101		E	000035		66	45	5	4	000	NON		00			2016	8	2015	
May's Point Rd	29th St E	0.16 (829)	N 2	70	20	2001		4	0	0	101	101		E	000035		66	45	5	4	000	NON		00			2016	8	2015	
29th St E	31st St (1.00)	1.00 (5280)	N 2	70	16	1970		4	0	0	102	102		E	000035		66	45	5	4	000	NON		00			2016	8	2015	

28th St E		0.75																												
AT RD/ST OFFSET MILES	TO ROAD NAME OFFSET MILES	LENGTH MILES (FEET)	OW L	SURFACE		MAINT		P	CURB SHOULDER		MEDIAN		ADT		ROW	FC	RC	SC	O	U/A	NHS	H	AC	ALN		INV	PVT		SW	
				Type	WD	YR	Type		YR	LT	RT	LT	RT	Type										WD	I		CNT	YR		I
17th St	18th Ave	0.50 (2640)	N 2	55	18	1970		4	0	0	102	102		E	000035		66	45	5	4	000	NON		00			2016	2	2015	
18th Ave	19th Ave (0.25)	0.25 (1320)	N 2	55	18	1970		4	0	0	102	102		E	000035		66	45	5	4	000	NON		00			2016	2	2015	

29th St E		1.31																												
AT RD/ST OFFSET MILES	TO ROAD NAME OFFSET MILES	LENGTH MILES (FEET)	OW L	SURFACE		MAINT		P	CURB SHOULDER		MEDIAN		ADT		ROW	FC	RC	SC	O	U/A	NHS	H	AC	ALN		INV	PVT		SW	
				Type	WD	YR	Type		YR	LT	RT	LT	RT	Type										WD	I		CNT	YR		I
CTH G	May's Point Rd	0.58 (3062)	N 2	55	24	2007		3	0	0	202	202		E	000035		66	45	5	4	000	NON		00			2016	8	2015	
May's Point Rd	22nd Ave	0.17 (898)	N 2	55	24	2007		3	0	0	202	202		E	000035		66	45	5	4	000	NON		00			2016	8	2015	
22nd Ave	May's Point Rd	0.31 (1637)	N 2	55	24	2007		3	0	0	202	202		E	000035		66	45	5	4	000	NON		00			2016	8	2015	
May's Point Rd	Termini (0.19)	0.19 (1003)	N 2	55	24	2007		3	0	0	202	202		E	000035		66	45	5	4	000	NON		00			2016	8	2015	
May's Point Rd (0.19)	Termini	0.06 (317)	N 1	55	24	2007		3	0	0	202	202		E	000035		50	45	5	4	000	NON		00			2016	8	2015	

STATE OF WISCONSIN
DEPARTMENT OF TRANSPORTATION
WISCONSIN INFORMATION SYSTEM FOR LOCAL ROADS

Inventory Listing With Maintenance (R-20)
1-1-2017 Certification

TOWN OF GERMANTOWN (012)

Certified Miles

30th St E		1.99																											
AT RD/ST OFFSET MILES	TO ROAD NAME OFFSET MILES	LENGTH MILES (FEET)	OW L	SURFACE		MAINT	P	CURB SHOULDER		MEDIAN		ADT		ROW		FC	RC	SC	O	U/A	NHS	H	AC	ALN	INV	PVT		SW	
				Type	WD			YR	LT	RT	RT	LT	TYPE	WD	I											CNT	YR		I
	17th St	0.08 (422)	N 2	40	16	1971	4	0	0	102	102	E	000015	E	66	45	5		4	000	NON		00			2016	3	2015	
	18th St	0.41 (2165)	N 2	40	22	2007	3	0	0	203	203	E	000015	E	66	45	5		4	000	NON		00			2016	3	2015	
	18th St	0.50 (2640)	N 2	40	20	2002	3	0	0	000	000	E	000015	E	50	45	5		4	000	NON		00			2016	3	2015	
	19th Ave	0.50 (2640)	N 2	70	20	2015	3	0	0	202	202	E	000035	E	66	45	5		4	000	NON		00			2016	10	2015	
	19th Ave (0.50)	0.50 (2640)	N 2	70	20	2008	3	0	0	202	202	E	000035	E	66	45	5		4	000	NON		00			2016	10	2015	

31st St		0.75																											
AT RD/ST OFFSET MILES	TO ROAD NAME OFFSET MILES	LENGTH MILES (FEET)	OW L	SURFACE		MAINT	P	CURB SHOULDER		MEDIAN		ADT		ROW		FC	RC	SC	O	U/A	NHS	H	AC	ALN	INV	PVT		SW	
				Type	WD			YR	LT	RT	RT	LT	TYPE	WD	I											CNT	YR		I
	22nd Ave (0.75)	0.75 (3960)	N 1	35	14	2012	4	0	0	102	102	E	000015	E	50	45	5		4	000	NON		00			2016	5	2015	

32nd St E		1.32																											
AT RD/ST OFFSET MILES	TO ROAD NAME OFFSET MILES	LENGTH MILES (FEET)	OW L	SURFACE		MAINT	P	CURB SHOULDER		MEDIAN		ADT		ROW		FC	RC	SC	O	U/A	NHS	H	AC	ALN	INV	PVT		SW	
				Type	WD			YR	LT	RT	RT	LT	TYPE	WD	I											CNT	YR		I
	Pine Ln	0.58 (3062)	N 2	55	20	2008	3	0	0	202	202	E	000035	E	66	45	5		4	000	NON		00			2016	7	2015	
	15th Ave	0.24 (1267)	N 2	55	20	2008	3	0	0	202	202	E	000035	E	66	45	5		4	000	NON		00			2016	7	2015	
	15th Ave	0.50 (2640)	N 2	55	20	2008	3	0	0	202	202	E	000035	E	66	45	5		4	000	NON		00			2016	7	2015	

STATE OF WISCONSIN
DEPARTMENT OF TRANSPORTATION
WISCONSIN INFORMATION SYSTEM FOR LOCAL ROADS

Inventory Listing With Maintenance (R-20)
1-1-2017 Certification

TOWN OF GERMANTOWN (012)

Rd/St Name

Certified Miles

37th St E		2.00																													
AT RD/ST OFFSET MILES	TO ROAD NAME OFFSET MILES	LENGTH MILES (FEET)	OW L	SURFACE		MAINT		CURB		SHOULDER		MEDIAN		ADT		ROW		FC	RC	SC	O	U/A	NHS	H	AC	ALN	INV	PVT	SW		
				Type	WD	YR	Type	YR	P	LT	RT	LT	RT	TYPE	WD	I	CNT	YR	I	W						H	V	YR	R	YR	
STH 58	Driftwood Ln	0.13 (705)	N 2	50	20	2003			4	0	0	202	202			E	000015		E	66	45	5	4	000	NON				2016	7	2015
Driftwood Ln	Driftwood Ln	0.29 (1530)	N 2	50	20	2003			4	0	0	202	202			E	000015		E	66	45	5	4	000	NON				2016	7	2015
Driftwood Ln	Wood Duck Ln	0.24 (1289)	N 2	50	20	2003			4	0	0	202	202			E	000015		E	66	45	5	4	000	NON				2016	7	2015
Wood Duck Ln	15th Ave	0.34 (1809)	N 2	50	20	2003			4	0	0	202	202			E	000015		E	66	45	5	4	000	NON				2016	7	2015
15th Ave	Apache Ln	0.16 (845)	N 2	50	20	2003			4	0	0	202	202			E	000015		E	66	45	5	4	000	NON				2016	7	2015
Apache Ln	Cherokee Ln	0.08 (407)	N 2	50	20	2003			4	0	0	202	202			E	000015		E	66	45	5	4	000	NON				2016	7	2015
Cherokee Ln	N Stone Gate Dr	0.01 (44)	N 2	50	20	2003			4	0	0	202	202			E	000015		E	66	45	5	4	000	NON				2016	7	2015
N Stone Gate Dr	S Stone Gate Dr	0.11 (597)	N 2	50	20	2003			4	0	0	202	202			E	000015		E	66	45	5	4	000	NON				2016	7	2015
S Stone Gate Dr	Half Moon Bay Dr W	0.32 (1698)	N 2	50	20	2003			4	0	0	202	202			E	000015		E	66	45	5	4	000	NON				2016	7	2015
Half Moon Bay Dr W	17th Ave	0.33 (1742)	N 2	50	20	2003			4	0	0	202	202			E	000015		E	66	45	5	4	000	NON				2016	7	2015

STATE OF WISCONSIN
 DEPARTMENT OF TRANSPORTATION
 WISCONSIN INFORMATION SYSTEM FOR LOCAL ROADS
 Inventory Listing With Maintenance (R-20)
 1-1-2017 Certification

TOWN OF GERMANTOWN (012)

Certified Miles

38th St		2.24																											
AT RD/ST OFFSET MILES	TO ROAD NAME OFFSET MILES	LENGTH MILES (FEET)	OW' L	SURFACE		MAINT	P	CURB SHOULDER		MEDIAN		ADT		ROW		FC	RC	SC	O	U/A	NHS	H	AC	ALN		INV	PVT		SW
				Type	WD			YR	LT	RT	RT	LT	TYPE	WD	I									CNT	YR		I	W	
STH 58	Trophy Dr	0.07 (370)	N 2	70	20	1996	1	2013	4	0	0	202	202	E	000035		5	45	5	4	000	NON	00			2016	6	2015	
Trophy Dr	Trophy Dr	0.20 (1056)	N 2	70	20	1996	1	2013	4	0	0	202	202	E	000035		5	45	5	4	000	NON	00			2016	6	2015	
Trophy Dr	15th Ave	0.57 (3009)	N 2	70	20	1996	1	2013	4	0	0	202	202	E	000035		5	45	5	4	000	NON	00			2016	6	2015	
15th Ave	16th Ave	0.50 (2640)	N 2	70	20	1996	1	2013	4	0	0	202	202	E	000035		5	45	5	4	000	NON	00			2016	7	2015	
16th Ave	17th Ave	0.51 (2693)	N 2	70	20	1996	1	2013	4	0	0	202	202	E	000035		5	45	5	4	000	NON	00			2016	7	2015	
17th Ave	Termini	0.39 (2059)	N 2	70	20	1997			4	0	0	102	102	E	000075		5	45	5	4	000	NON	00			2016	7	2015	

40th St E		1.26																											
AT RD/ST OFFSET MILES	TO ROAD NAME OFFSET MILES	LENGTH MILES (FEET)	OW' L	SURFACE		MAINT	P	CURB SHOULDER		MEDIAN		ADT		ROW		FC	RC	SC	O	U/A	NHS	H	AC	ALN		INV	PVT		SW
				Type	WD			YR	LT	RT	RT	LT	TYPE	WD	I									CNT	YR		I	W	
19th Ave	Peiras Ln	0.50 (2640)	N 2	70	18	2013	1	2015	4	0	0	102	102	E	000035		5	45	5	4	000	NON	00			2016	10	2015	
Peiras Ln	20th Ave S	0.25 (1320)	N 2	70	18	2013	1	2015	4	0	0	102	102	E	000035		5	45	5	4	000	NON	00			2016	10	2015	
20th Ave S	CTH G	0.51 (2693)	N 2	70	18	2012	1	2015	4	0	0	102	102	E	000035		5	45	5	4	000	NON	00			2016	10	2015	

41st St		2.22																											
AT RD/ST OFFSET MILES	TO ROAD NAME OFFSET MILES	LENGTH MILES (FEET)	OW' L	SURFACE		MAINT	P	CURB SHOULDER		MEDIAN		ADT		ROW		FC	RC	SC	O	U/A	NHS	H	AC	ALN		INV	PVT		SW
				Type	WD			YR	LT	RT	RT	LT	TYPE	WD	I									CNT	YR		I	W	
CTH G	J Ziilinski Ln	0.51 (2693)	N 2	70	16	2010	1	2015	4	0	0	201	201	E	000035		5	45	5	4	000	NON	00			2016	10	2015	
J Ziilinski Ln	20th Ave S	0.51 (2693)	N 2	70	16	2010	1	2015	4	0	0	201	201	E	000035		5	45	5	4	000	NON	00			2016	10	2015	
20th Ave S	19th Ave	0.78 (4118)	N 2	70	20	2011	1	2015	0	0	0	102	202	1	78	E	000035		5	4	000	NON	00			2016	10	2015	
19th Ave	Termini	0.42 (2218)	N 2	70	20	2011			0	0	0	102	202	1	78	E	000005		5	4	000	NON	00			2016	10	2015	

STATE OF WISCONSIN
 DEPARTMENT OF TRANSPORTATION
 WISCONSIN INFORMATION SYSTEM FOR LOCAL ROADS
 Inventory Listing With Maintenance (R-20)
 1-1-2017 Certification

TOWN OF GERMANTOWN (012)

Certified Miles

43rd St W		1.91																										
AT RD/ST OFFSET MILES	TO ROAD NAME OFFSET MILES	LENGTH MILES (FEET)	OW L	SURFACE		MAINT	P	CURB SHOULDER		MEDIAN		ADT		ROW		FC	RC	SC	O	U/A	NHS	H	AC	ALN H V	INV YR	PVT		SW
				Type	YR			YR	Type	WD	I	CNT	YR	I	W											YR	R	
15th Ave (0.59)	19th Ave	1.41 (7445)	N 2	55	24	2005	7	2015	3	0	0	303	303	E	000035	E	66	45	5	4	000	NON	00		2016	8	2015	
19th Ave (0.51)	20th Ave S	0.50 (2640)	N 2	55	20	1971			4	0	0	102	102	E	000015	E	50	45	5	4	000	NON	00		2016	8	2015	

Alice Ln		0.31																										
AT RD/ST OFFSET MILES	TO ROAD NAME OFFSET MILES	LENGTH MILES (FEET)	OW L	SURFACE		MAINT	P	CURB SHOULDER		MEDIAN		ADT		ROW		FC	RC	SC	O	U/A	NHS	H	AC	ALN H V	INV YR	PVT		SW
				Type	YR			YR	Type	WD	I	CNT	YR	I	W											YR	R	
Godfrey Dr	Sullivan's Ln	0.31 (1637)	N 2	40	18	1982			4	0	0	103	103	E	000015	A	66	45	5	4	000	NON	00		2016	5	2015	

Apache Ln		0.25																										
AT RD/ST OFFSET MILES	TO ROAD NAME OFFSET MILES	LENGTH MILES (FEET)	OW L	SURFACE		MAINT	P	CURB SHOULDER		MEDIAN		ADT		ROW		FC	RC	SC	O	U/A	NHS	H	AC	ALN H V	INV YR	PVT		SW
				Type	YR			YR	Type	WD	I	CNT	YR	I	W											YR	R	
Cherokee Ln	Sioux Ln	0.06 (317)	N 2	40	21	2008			3	0	0	202	202	E	000015	E	66	45	5	4	000	NON	00		2016	4	2015	
Sioux Ln	Sioux Ln	0.14 (739)	N 2	40	21	2008			3	0	0	202	202	E	000015	E	66	45	5	4	000	NON	00		2016	4	2015	
Sioux Ln	37th St E	0.05 (264)	N 2	40	21	2008			3	0	0	202	202	E	000015	E	66	45	5	4	000	NON	00		2016	4	2015	

Bailey's Blvd		0.35																										
AT RD/ST OFFSET MILES	TO ROAD NAME OFFSET MILES	LENGTH MILES (FEET)	OW L	SURFACE		MAINT	P	CURB SHOULDER		MEDIAN		ADT		ROW		FC	RC	SC	O	U/A	NHS	H	AC	ALN H V	INV YR	PVT		SW
				Type	YR			YR	Type	WD	I	CNT	YR	I	W											YR	R	
Termini	Bayshore Dr	0.07 (383)	N 2	70	20	2008									000000	A	66	45	5	4	000	NON	00		2016	10	2015	
Bayshore Dr	Windcrest Ct	0.20 (1078)	N 2	70	20	2008									000000	A	66	45	5	4	000	NON	00		2016	10	2015	
Windcrest Ct	Termini	0.04 (233)	N 2	70	20	2008									000000	A	66	45	5	4	000	NON	00		2016	10	2015	

STATE OF WISCONSIN
 DEPARTMENT OF TRANSPORTATION
 WISCONSIN INFORMATION SYSTEM FOR LOCAL ROADS
 Inventory Listing With Maintenance (R-20)
 1-1-2017 Certification

TOWN OF GERMANTOWN (012)

Certified Miles

Barbara Ln		0.31		SURFACE		MAINT		CURB		SHOULDER		MEDIAN		ADT		ROW		FC		RC		SC		O		U/A		NHS		H		AC		ALN		INV		PVT		SW	
AT RD/ST OFFSET MILES	TO ROAD NAME OFFSET MILES	LENGTH MILES (FEET)	OW' L	Type	WD	YR	Type	YR	P	LT	RT	LT	RT	TYPE	WD	I	CNT	YR	I	W	FC	RC	SC	O	U/A	NHS	H	AC	H	V	YR	YR	R	YR	R	YR					
Sullivan's Ln	Godfrey Dr	0.31 (1636)	N 2 40	18	20	1982			4	0	0	103	103			E	000015		A	66	45	5	4	000	NON	NON	00						2016	4	2015						

Bayshore Dr		0.33		SURFACE		MAINT		CURB		SHOULDER		MEDIAN		ADT		ROW		FC		RC		SC		O		U/A		NHS		H		AC		ALN		INV		PVT		SW	
AT RD/ST OFFSET MILES	TO ROAD NAME OFFSET MILES	LENGTH MILES (FEET)	OW' L	Type	WD	YR	Type	YR	P	LT	RT	LT	RT	TYPE	WD	I	CNT	YR	I	W	FC	RC	SC	O	U/A	NHS	H	AC	H	V	YR	YR	R	YR	R	YR					
Bailey's Blvd	CTH G	0.33 (1717)	N 2 70	20	2008							204	204				000000		A	66	45	5	4	000	NON	NON	00						2016	10	2015						

Beach Ct		0.07		SURFACE		MAINT		CURB		SHOULDER		MEDIAN		ADT		ROW		FC		RC		SC		O		U/A		NHS		H		AC		ALN		INV		PVT		SW	
AT RD/ST OFFSET MILES	TO ROAD NAME OFFSET MILES	LENGTH MILES (FEET)	OW' L	Type	WD	YR	Type	YR	P	LT	RT	LT	RT	TYPE	WD	I	CNT	YR	I	W	FC	RC	SC	O	U/A	NHS	H	AC	H	V	YR	YR	R	YR	R	YR					
Termini	Beach Dr	0.07 (370)	N 2 40	22	2005				3	0	0	000	000			E	000015		A	66	45	5	4	000	NON	NON	00						2016	4	2015						

Beach Dr		1.23		SURFACE		MAINT		CURB		SHOULDER		MEDIAN		ADT		ROW		FC		RC		SC		O		U/A		NHS		H		AC		ALN		INV		PVT		SW	
AT RD/ST OFFSET MILES	TO ROAD NAME OFFSET MILES	LENGTH MILES (FEET)	OW' L	Type	WD	YR	Type	YR	P	LT	RT	LT	RT	TYPE	WD	I	CNT	YR	I	W	FC	RC	SC	O	U/A	NHS	H	AC	H	V	YR	YR	R	YR	R	YR					
STH 58	Woodland Trl	0.09 (475)	N 2 40	24	2006				3	0	0	202	202	0	0	E	000045		A	66	45	5	4	000	NON	NON	00						2016	4	2015						
Woodland Trl	Woodland Trl	0.41 (2165)	N 2 40	24	2006				3	0	0	202	202	0	0	E	000045		A	66	45	5	4	000	NON	NON	00						2016	4	2015						
Woodland Trl	Timber Trl	0.07 (370)	N 2 40	24	2006				3	0	0	202	202	0	0	E	000045		A	66	45	5	4	000	NON	NON	00						2016	4	2015						
Timber Trl	Oak Hollow Trl	0.08 (422)	N 2 40	24	2006				3	0	0	202	202	0	0	E	000045		A	66	45	5	4	000	NON	NON	00						2016	4	2015						
Oak Hollow Trl	Beach Ct	0.41 (2165)	N 2 40	22	2006				3	0	0	202	202	0	0	E	000045		A	66	45	5	4	000	NON	NON	00						2016	4	2015						
Beach Ct	Timber Trl	0.08 (422)	N 2 40	24	2006				3	0	0	202	202	0	0	E	000045		A	66	45	5	4	000	NON	NON	00						2016	4	2015						
Timber Trl	15th Ave	0.09 (475)	N 2 40	24	2006				3	0	0	202	202	0	0	E	000045		A	66	45	5	4	000	NON	NON	00						2016	4	2015						

STATE OF WISCONSIN
 DEPARTMENT OF TRANSPORTATION
 WISCONSIN INFORMATION SYSTEM FOR LOCAL ROADS
 Inventory Listing With Maintenance (R-20)
 1-1-2017 Certification

TOWN OF GERMANTOWN (012)

Certified Miles

Bean Ln		0.25																										
AT RD/ST OFFSET MILES	TO ROAD NAME OFFSET MILES	LENGTH MILES (FEET)	OW L	SURFACE		MAINT		CURB SHOULDER		MEDIAN	ADT		ROW		FC	RC	SC	O	U/A	NHS	H	AC	ALN		INV	PVT		SW
				Type	WD	YR	Type	YR	P		LT	RT	LT	RT									Type	WD		I	CNT	
Termini	15th Ave	0.25 (1320)	N 1	35	8	1970		4	0	0	000	000	E	000015	E	66	45	5	4	000	NON		00		2016	3	2015	

Big Oak Dr		0.47																										
AT RD/ST OFFSET MILES	TO ROAD NAME OFFSET MILES	LENGTH MILES (FEET)	OW L	SURFACE		MAINT		CURB SHOULDER		MEDIAN	ADT		ROW		FC	RC	SC	O	U/A	NHS	H	AC	ALN		INV	PVT		SW
				Type	WD	YR	Type	YR	P		LT	RT	LT	RT									Type	WD		I	CNT	
Evergreen St	E Side Ct	0.20 (1056)	N 2	70	20	2007		4	0	0	101	101	E	000015	E	66	45	5	4	000	NON		00		2016	9	2015	
E Side Ct	Termini	0.10 (528)	N 2	70	20	2007		3	0	0	202	202	E	000015	E	66	45	5	4	000	NON		00		2016	9	2015	
Termini	Termini	0.17 (898)	N 2	70	20	2007		4	0	0	101	101	E	000015	E	66	45	5	4	000	NON		00		2016	9	2015	

Blue Water Ct		0.12																										
AT RD/ST OFFSET MILES	TO ROAD NAME OFFSET MILES	LENGTH MILES (FEET)	OW L	SURFACE		MAINT		CURB SHOULDER		MEDIAN	ADT		ROW		FC	RC	SC	O	U/A	NHS	H	AC	ALN		INV	PVT		SW
				Type	WD	YR	Type	YR	P		LT	RT	LT	RT									Type	WD		I	CNT	
N Stone Gate Dr	Termini	0.11 (605)	N 2	70	20	2008								000000	A	66	45	5	4	000	NON		00		2016	10	2015	

Boaters Dream Dr		0.46																										
AT RD/ST OFFSET MILES	TO ROAD NAME OFFSET MILES	LENGTH MILES (FEET)	OW L	SURFACE		MAINT		CURB SHOULDER		MEDIAN	ADT		ROW		FC	RC	SC	O	U/A	NHS	H	AC	ALN		INV	PVT		SW
				Type	WD	YR	Type	YR	P		LT	RT	LT	RT									Type	WD		I	CNT	
Dam Rd	Glacier Rd	0.33 (1742)	N 2	70	22	2005								000000	A	66	45	5	4	000	NON		00		2016	10	2015	
Glacier Rd	Termini	0.09 (475)	N 2	70	22	2005								000000	A	66	45	5	4	000	NON		00		2016	10	2015	

Cabin Ct		0.06																										
AT RD/ST OFFSET MILES	TO ROAD NAME OFFSET MILES	LENGTH MILES (FEET)	OW L	SURFACE		MAINT		CURB SHOULDER		MEDIAN	ADT		ROW		FC	RC	SC	O	U/A	NHS	H	AC	ALN		INV	PVT		SW
				Type	WD	YR	Type	YR	P		LT	RT	LT	RT									Type	WD		I	CNT	
Driftwood Ln	Termini	0.03 (149)	N 2	70	24	2010								000000	A	66	45	5	4	000	NON		00		2016	10	2015	

**STATE OF WISCONSIN
DEPARTMENT OF TRANSPORTATION
WISCONSIN INFORMATION SYSTEM FOR LOCAL ROADS**
Inventory Listing With Maintenance (R-20)
1-1-2017 Certification

TOWN OF GERMANTOWN (012)

Rd/St Name Certified Miles

Castaway Dr		1.05																										
AT RD/ST OFFSET MILES	TO ROAD NAME OFFSET MILES	LENGTH MILES (FEET)	OW L	SURFACE		MAINT	P	CURB SHOULDER		MEDIAN	ADT		ROW		FC	RC	SC	O	U/A	NHS	H	AC	ALN		INV	PVT		SW
				Type	WD			YR	LT		RT	Type	WD	I									CNT	YR		I	W	
15th Ave	Kayak Ct	0.18 (957)	N 2	70	20	2013	3		202	202		000000	A	66	45	5		4	000			00			2016	10	2015	
Kayak Ct	North Shore Dr	0.52 (2730)	N 2	70	20	2013	3		202	202		000000	A	66	45	5		4	000			00			2016	10	2015	
North Shore Dr	15th Ave	0.35 (1830)	N 2	70	20	2013	3		202	202		000000	A	66	45	5		4	000			00			2016	10	2015	

Castle Ct		0.10																										
AT RD/ST OFFSET MILES	TO ROAD NAME OFFSET MILES	LENGTH MILES (FEET)	OW L	SURFACE		MAINT	P	CURB SHOULDER		MEDIAN	ADT		ROW		FC	RC	SC	O	U/A	NHS	H	AC	ALN		INV	PVT		SW
				Type	WD			YR	LT		RT	Type	WD	I									CNT	YR		I	W	
Evergreen St	Termini	0.10 (528)	N 2	70	20	2007	3	0	0	202	202	E	60	45	5		4	000	NON	NON		00			2016	10	2015	

Cherokee Ln		0.46																										
AT RD/ST OFFSET MILES	TO ROAD NAME OFFSET MILES	LENGTH MILES (FEET)	OW L	SURFACE		MAINT	P	CURB SHOULDER		MEDIAN	ADT		ROW		FC	RC	SC	O	U/A	NHS	H	AC	ALN		INV	PVT		SW
				Type	WD			YR	LT		RT	Type	WD	I									CNT	YR		I	W	
37th St E	Meadow Dr	0.18 (950)	N 2	40	22	2002			00	00		000000	E	66	45	5		4	000	NON	NON	00			2016	3	2015	
Meadow Dr	Apache Ln	0.10 (528)	N 2	40	22	2002	4	0	0	000	000	E	66	45	5		4	000	NON	NON	00			2016	3	2015		
Apache Ln	15th Ave	0.17 (898)	N 2	40	22	2002	4	0	0	000	000	E	66	45	5		4	000	NON	NON	00			2016	3	2015		

Clearwater Dr		0.82																										
AT RD/ST OFFSET MILES	TO ROAD NAME OFFSET MILES	LENGTH MILES (FEET)	OW L	SURFACE		MAINT	P	CURB SHOULDER		MEDIAN	ADT		ROW		FC	RC	SC	O	U/A	NHS	H	AC	ALN		INV	PVT		SW
				Type	WD			YR	LT		RT	Type	WD	I									CNT	YR		I	W	
15th Ave	15th Ave	0.82 (4341)	N 2	70	20	2008			204	204		000000	A	66	45	5		4	000	NON	NON	00			2016	10	2015	

Collie Dr		0.17																										
AT RD/ST OFFSET MILES	TO ROAD NAME OFFSET MILES	LENGTH MILES (FEET)	OW L	SURFACE		MAINT	P	CURB SHOULDER		MEDIAN	ADT		ROW		FC	RC	SC	O	U/A	NHS	H	AC	ALN		INV	PVT		SW
				Type	WD			YR	LT		RT	Type	WD	I									CNT	YR		I	W	
17th Ave	Jones Ave	0.17 (898)	N 2	40	24	2005	3	0	0	104	104	E	66	45	5		4	000	NON	NON	00			2016	4	2015		

STATE OF WISCONSIN
 DEPARTMENT OF TRANSPORTATION
 WISCONSIN INFORMATION SYSTEM FOR LOCAL ROADS
 Inventory Listing With Maintenance (R-20)
 1-1-2017 Certification

TOWN OF GERMANTOWN (012)

Rd/St Name Certified Miles

Copper Point Dr		0.30																												
AT RD/ST OFFSET MILES	TO ROAD NAME OFFSET MILES	LENGTH MILES (FEET)	OW' L	SURFACE		MAINT	P	CURB		SHOULDER		MEDIAN		ADT		ROW	FC	RC	SC	O	U/A	NHS	H	AC	ALN	INV	PVT		SW	
				Type	WD			YR	LT	RT	LT	RT	TYPE	WD	I												CNT	YR		I
North Shore Dr	North Shore Dr	0.30 (1571)	N	2	70	20	2008			204	204				000000	A	66	45	5	4	000	NON		00			2016	10	2015	

CTH G		13.45																												
AT RD/ST OFFSET MILES	TO ROAD NAME OFFSET MILES	LENGTH MILES (FEET)	OW' L	SURFACE		MAINT	P	CURB		SHOULDER		MEDIAN		ADT		ROW	FC	RC	SC	O	U/A	NHS	H	AC	ALN	INV	PVT		SW	
				Type	WD			YR	LT	RT	LT	RT	TYPE	WD	I												CNT	YR		I
44th St E (0.27)	CTH HH	0.35 (1848)	N	2	70	22	2008	4	0	0	203	203		T	000120	E	66	40	4	3	000	NON	N	00			2016	8	2015	
CTH HH	41st St	1.20 (6336)	N	2	65	22	2014	4	0	0	104	104		A	000320	E	66	30	4	3	000	NON	N	00			2016	8	2015	
41st St	Private	0.10 (528)	N	2	65	22	2014	4	0	0	104	104		A	000320	E	66	30	4	3	000	NON	N	00			2016	8	2015	
Private	Ridgewater Dr	0.33 (1745)	N	2	65	22	2014	4	0	0	104	104		A	000680	E	66	30	4	3	000	NON	N	06			2016	8	2015	
Ridgewater Dr	40th St E	0.31 (1634)	N	2	65	22	2014	4	0	0	104	104		A	000680	E	66	30	4	3	000	NON	N	06			2016	8	2015	
40th St E	Lake Rd	0.91 (4805)	N	2	65	22	2014	4	0	0	104	104		A	000680	E	66	30	4	3	000	NON	N	06			2016	8	2015	
Lake Rd	High Ridge Rd	0.15 (766)	N	2	65	22	2014	4	0	0	104	104		A	000680	E	66	30	4	3	000	NON	N	06			2016	8	2015	
High Ridge Rd	Sandstone Dr	0.20 (1082)	N	2	65	22	2014	4	0	0	104	104		A	000680	E	66	30	4	3	000	NON	N	06			2016	8	2015	
Sandstone Dr	19th Ave	0.17 (898)	N	2	65	22	2014	4	0	0	104	104		A	000680	E	66	30	4	3	000	NON	N	06			2016	8	2015	
19th Ave	Shacks Rd	0.59 (3115)	N	2	65	22	2014	4	0	0	104	104		A	000680	E	66	30	4	3	000	NON	N	06			2016	8	2015	
Shacks Rd	17th Ave	0.64 (3379)	N	2	65	22	2014	4	0	0	104	104		A	000680	E	66	30	4	3	000	NON	N	06			2016	8	2015	
17th Ave	16th Ave	0.50 (2640)	N	2	65	22	2014	4	0	0	104	104		A	000680	E	66	30	4	3	000	NON	N	06			2016	8	2015	
16th Ave	Godfrey Dr	0.15 (792)	N	2	65	22	2014	4	0	0	104	104		A	000680	E	66	30	4	3	000	NON	N	06			2016	8	2015	
Godfrey Dr	15th Ave	0.35 (1848)	N	2	65	22	2014	4	0	0	104	104		A	000680	E	66	30	4	3	000	NON	N	06			2016	8	2015	

STATE OF WISCONSIN
DEPARTMENT OF TRANSPORTATION
WISCONSIN INFORMATION SYSTEM FOR LOCAL ROADS

Inventory Listing With Maintenance (R-20)
1-1-2017 Certification

TOWN OF GERMANTOWN (012)

Certified Miles

Rd/St Name		Certified Miles																															
CTH G		13.45																															
AT RD/ST OFFSET MILES	TO ROAD NAME OFFSET MILES	LENGTH MILES (FEET)	OW' L	SURFACE		MAINT		CURB		SHOULDER		MEDIAN		ADT		ROW		FC	RC	SC	O	U/A	NHS	H	AC	ALN	INV	PVT	SW				
				Type	WD	YR	Type	YR	LT	RT	LT	RT	TYPE	WD	I	CNT	YR	I	W							H	V	YR	R	YR			
	Nordall Ln (0.94)	0.65 (3432)	N 2	65	22	2014			4	0	0	0	202	202		A	000220		E	66	30	4			3	000	NON	N	00		2016	8	2015
	31st St	0.49 (2587)	N 2	65	22	2014			0	0	0	0	203	203		A	000220		E	66	30	4			3	000	NON	N	00		2016	8	2015
	30th St E	0.47 (2482)	N 2	65	22	2014			0	0	0	0	203	203		A	000220		E	66	30	4			3	000	NON	N	00		2016	8	2015
	29th St E	0.50 (2640)	N 2	65	22	2014			0	0	0	0	203	203		A	000220		E	66	30	4			3	000	NON	N	00		2016	8	2015

CTH HH		0.35																															
AT RD/ST OFFSET MILES	TO ROAD NAME OFFSET MILES	LENGTH MILES (FEET)	OW' L	SURFACE		MAINT		CURB		SHOULDER		MEDIAN		ADT		ROW		FC	RC	SC	O	U/A	NHS	H	AC	ALN	INV	PVT	SW				
				Type	WD	YR	Type	YR	LT	RT	LT	RT	TYPE	WD	I	CNT	YR	I	W							H	V	YR	R	YR			
	Glacier Rd	0.16 (854)	N 2	65	22	2014			4	0	0	0	104	104		A	000250		E	66	30	4			3	000	NON	N	00		2016	8	2015
	Dam Rd	0.14 (730)	N 2	65	22	2014			4	0	0	0	104	104		A	000250		E	66	30	4			3	000	NON	N	00		2016	8	2015
	Dam Rd	0.05 (264)	N 2	65	22	2014			4	0	0	0	104	104		A	000250		E	66	30	4			3	000	NON	N	00		2016	8	2015

Dam Rd		0.53																															
AT RD/ST OFFSET MILES	TO ROAD NAME OFFSET MILES	LENGTH MILES (FEET)	OW' L	SURFACE		MAINT		CURB		SHOULDER		MEDIAN		ADT		ROW		FC	RC	SC	O	U/A	NHS	H	AC	ALN	INV	PVT	SW				
				Type	WD	YR	Type	YR	LT	RT	LT	RT	TYPE	WD	I	CNT	YR	I	W							H	V	YR	R	YR			
	Boaters Dream Dr	0.21 (1089)	N 2	70	20	2004			4	0	0	0	102	102		E	000015		E	66	45	5			4	000	NON	N	00		2016	9	2015
	Boaters Dream Dr	0.32 (1709)	N 2	70	20	2004			4	0	0	0	102	102		E	000015		E	66	45	5			4	000	NON	N	00		2016	9	2015

**STATE OF WISCONSIN
DEPARTMENT OF TRANSPORTATION
WISCONSIN INFORMATION SYSTEM FOR LOCAL ROADS**
Inventory Listing With Maintenance (R-20)
1-1-2017 Certification

TOWN OF GERMANTOWN (012)

Rd/St Name

Certified Miles

Deer Path		0.24																												
AT RD/ST OFFSET MILES	TO ROAD NAME OFFSET MILES	LENGTH MILES (FEET)	OW L	SURFACE		MAINT		P	CURB SHOULDER		MEDIAN		ADT		ROW		FC	RC	SC	O	U/A	NHS	H	AC	ALN H V	INV YR	PVT		SW	
				Type	WD	YR	Type		YR	LT	RT	LT	RT	Type	WD	I											CNT	YR		I
	Termini	0.03 (158)	N 2	40	20	2000			4	0	0	000	000	E	000015		E	66	45	5	4	000	NON				2016	5	2015	
	Whistling Wings Dr	0.09 (475)	N 2	40	20	2000			4	0	0	000	000	E	000015		E	66	45	5	4	000	NON				2016	5	2015	
	Quail Dr	0.08 (422)	N 2	40	20	2000			4	0	0	000	000	E	000015		E	66	45	5	4	000	NON				2016	5	2015	
	Pheasant Dr	0.04 (211)	N 2	40	20	2000			4	0	0	000	000	E	000015		E	66	45	5	4	000	NON				2016	5	2015	

Driftwood Ln		0.25																											
AT RD/ST OFFSET MILES	TO ROAD NAME OFFSET MILES	LENGTH MILES (FEET)	OW L	SURFACE		MAINT		P	CURB SHOULDER		MEDIAN		ADT		ROW		FC	RC	SC	O	U/A	NHS	H	AC	ALN H V	INV YR	PVT		SW
				Type	WD	YR	Type		YR	LT	RT	LT	RT	Type	WD	I											CNT	YR	
	37th St E	0.20 (1070)	N 2	70	24	2010										A	66	45	5	4	000	NON				2016	10	2015	
	Cabin Ct	0.06 (294)	N 2	70	24	2010										A	66	45	5	4	000	NON				2016	10	2015	

Etiers Way		0.50																												
AT RD/ST OFFSET MILES	TO ROAD NAME OFFSET MILES	LENGTH MILES (FEET)	OW L	SURFACE		MAINT		P	CURB SHOULDER		MEDIAN		ADT		ROW		FC	RC	SC	O	U/A	NHS	H	AC	ALN H V	INV YR	PVT		SW	
				Type	WD	YR	Type		YR	LT	RT	LT	RT	Type	WD	I											CNT	YR		I
	Haagenson Cir	0.12 (634)	N 2	40	22	2000			4	0	0	000	000	E	000005		A	66	45	5	4	000	NON				2016	5	2015	
	Presnell Ct	0.05 (264)	N 2	40	22	2000			4	0	0	000	000	E	000005		A	66	45	5	4	000	NON				2016	5	2015	
	Horny Pl	0.21 (1108)	N 2	40	22	2000			4	0	0	000	000	E	000005		A	66	45	5	4	000	NON				2016	5	2015	
	Jim Legge Dr	0.12 (634)	N 2	40	22	2000			4	0	0	000	000	E	000005		A	66	45	5	4	000	NON				2016	5	2015	

Evergreen Ln		0.18																												
AT RD/ST OFFSET MILES	TO ROAD NAME OFFSET MILES	LENGTH MILES (FEET)	OW L	SURFACE		MAINT		P	CURB SHOULDER		MEDIAN		ADT		ROW		FC	RC	SC	O	U/A	NHS	H	AC	ALN H V	INV YR	PVT		SW	
				Type	WD	YR	Type		YR	LT	RT	LT	RT	Type	WD	I											CNT	YR		I
	Oakwood Ln	0.18 (950)	N 2	70	18	2008			3	0	0	203	203	E	000050		E	66	45	5	4	000	NON				2016	9	2015	

**STATE OF WISCONSIN
DEPARTMENT OF TRANSPORTATION
WISCONSIN INFORMATION SYSTEM FOR LOCAL ROADS**
Inventory Listing With Maintenance (R-20)
1-1-2017 Certification

TOWN OF GERMANTOWN (012)

Rd/St Name Certified Miles

Evergreen St		0.21																											
AT RD/ST OFFSET MILES	TO ROAD NAME OFFSET MILES	LENGTH MILES (FEET)	OW L	SURFACE		MAINT	P	CURB SHOULDER		MEDIAN		ADT		ROW		FC	RC	SC	O	U/A	NHS	H	AC	ALN		INV	PVT		SW
				Type	WD			YR	LT	RT	Type	WD	I	CNT	YR									I	W		H	V	
	Big Oak Dr	0.01 (53)	N 2	70	20	2007	4	0	0	202	202	E	000035	E	66	45	5	4	000	NON	00					2016	9	2015	
	Red Oak Ct	0.04 (211)	N 2	70	20	2007	4	0	0	202	202	E	000035	E	66	45	5	4	000	NON	00					2016	9	2015	
	Red Oak Ct	0.09 (475)	N 2	70	20	2007	4	0	0	202	202	E	000035	E	66	45	5	4	000	NON	00					2016	9	2015	
	Castle Ct	0.06 (317)	N 2	70	20	2007	4	0	0	202	202	E	000035	E	66	45	5	4	000	NON	00					2016	9	2015	
	Castle Ct (0.06)	0.01 (52)	N 2	70	20	2007	4	0	0	202	202	E	000015	E	60	45	5	4	000	NON	00					2016	9	2015	

Forkhorn Ct

Forkhorn Ct		0.12																											
AT RD/ST OFFSET MILES	TO ROAD NAME OFFSET MILES	LENGTH MILES (FEET)	OW L	SURFACE		MAINT	P	CURB SHOULDER		MEDIAN		ADT		ROW		FC	RC	SC	O	U/A	NHS	H	AC	ALN		INV	PVT		SW
				Type	WD			YR	LT	RT	Type	WD	I	CNT	YR									I	W		H	V	
	Termini	0.12 (634)	N 2	40	20	2003	4	0	0	202	202	0	000000	A	66	45	5	4	000	NON	00					2016	3	2015	

Glacier Rd

Glacier Rd		0.10																											
AT RD/ST OFFSET MILES	TO ROAD NAME OFFSET MILES	LENGTH MILES (FEET)	OW L	SURFACE		MAINT	P	CURB SHOULDER		MEDIAN		ADT		ROW		FC	RC	SC	O	U/A	NHS	H	AC	ALN		INV	PVT		SW
				Type	WD			YR	LT	RT	Type	WD	I	CNT	YR									I	W		H	V	
	Boaters Dream Dr	0.09 (475)	N 2	70	22	2005				204	204		000000	A	66	45	5	4	000	NON	00					2016	10	2015	

Godfrey Dr

Godfrey Dr		0.44																											
AT RD/ST OFFSET MILES	TO ROAD NAME OFFSET MILES	LENGTH MILES (FEET)	OW L	SURFACE		MAINT	P	CURB SHOULDER		MEDIAN		ADT		ROW		FC	RC	SC	O	U/A	NHS	H	AC	ALN		INV	PVT		SW
				Type	WD			YR	LT	RT	Type	WD	I	CNT	YR									I	W		H	V	
	Alice Ln	0.32 (1690)	N 2	40	18	2009	4	0	0	103	103	E	000015	A	66	45	5	4	000	NON	00					2016	4	2015	
	Barbara Ln	0.12 (634)	N 2	40	18	2009	4	0	0	103	103	E	000015	A	66	45	5	4	000	NON	00					2016	4	2015	

STATE OF WISCONSIN
 DEPARTMENT OF TRANSPORTATION
 WISCONSIN INFORMATION SYSTEM FOR LOCAL ROADS
 Inventory Listing With Maintenance (R-20)
 1-1-2017 Certification

TOWN OF GERMANTOWN (012)

Certified Miles

Haagenson Cir		0.19																											
AT RD/ST OFFSET MILES	TO ROAD NAME OFFSET MILES	LENGTH MILES (FEET)	OW L	SURFACE		MAINT		CURB SHOULDER		MEDIAN		ADT		ROW		FC	RC	SC	O	U/A	NHS	H	AC	ALN H V	INV YR	PVT		SW	
				Type	YR	Type	YR	P	LT	RT	LT	RT	Type	WD	I											CNT	YR		I
	Unknown	0.02 (106)	N 2	40	18	1982			4	0	0	104	104	E	000005	A	66	45	5	4	000	NON				2016	5	2015	
	Unknown	0.04 (211)	N 2	40	18	1982			4	0	0	104	104	E	000005	A	66	45	5	4	000	NON				2016	5	2015	
	Etiers Way	0.04 (211)	N 2	40	18	1982			4	0	0	104	104	E	000005	A	66	45	5	4	000	NON				2016	5	2015	
	Etiers Way	0.04 (211)	N 2	40	18	1982			4	0	0	104	104	E	000005	A	66	45	5	4	000	NON				2016	5	2015	
	Wally Way	0.05 (264)	N 2	40	18	1982			4	0	0	104	104	E	000005	A	66	45	5	4	000	NON				2016	5	2015	

Half Moon Bay Dr E		0.60																											
AT RD/ST OFFSET MILES	TO ROAD NAME OFFSET MILES	LENGTH MILES (FEET)	OW L	SURFACE		MAINT		CURB SHOULDER		MEDIAN		ADT		ROW		FC	RC	SC	O	U/A	NHS	H	AC	ALN H V	INV YR	PVT		SW	
				Type	YR	Type	YR	P	LT	RT	LT	RT	Type	WD	I											CNT	YR		I
	Half Moon Bay Dr W	0.60 (3168)	N 2	55	24	2008			3	0	0	202	202	E	000075	A	66	45	5	4	000	NON				2016	8	2015	

Half Moon Bay Dr W		0.58																											
AT RD/ST OFFSET MILES	TO ROAD NAME OFFSET MILES	LENGTH MILES (FEET)	OW L	SURFACE		MAINT		CURB SHOULDER		MEDIAN		ADT		ROW		FC	RC	SC	O	U/A	NHS	H	AC	ALN H V	INV YR	PVT		SW	
				Type	YR	Type	YR	P	LT	RT	LT	RT	Type	WD	I											CNT	YR		I
	Meadow Dr	0.36 (1901)	N 2	55	24	2008			3	0	0	202	202	E	000075	A	66	45	5	4	000	NON				2016	8	2015	
	Half Moon Bay Dr E	0.18 (950)	N 2	55	24	2008			3	0	0	202	202	E	000075	A	66	45	5	4	000	NON				2016	8	2015	
	Half Moon Bay Dr E	0.04 (211)	N 2	55	24	2008			3	0	0	202	202	E	000075	A	66	45	5	4	000	NON				2016	8	2015	

High Ridge Rd		0.16																											
AT RD/ST OFFSET MILES	TO ROAD NAME OFFSET MILES	LENGTH MILES (FEET)	OW L	SURFACE		MAINT		CURB SHOULDER		MEDIAN		ADT		ROW		FC	RC	SC	O	U/A	NHS	H	AC	ALN H V	INV YR	PVT		SW	
				Type	YR	Type	YR	P	LT	RT	LT	RT	Type	WD	I											CNT	YR		I
	South Shore Rd	0.16 (845)	N 2	70	20	2003			4	0	0	202	202	E	000000	A	66	45	5	4	000	NON				2016	10	2015	

STATE OF WISCONSIN
 DEPARTMENT OF TRANSPORTATION
 WISCONSIN INFORMATION SYSTEM FOR LOCAL ROADS
 Inventory Listing With Maintenance (R-20)
 1-1-2017 Certification

TOWN OF GERMANTOWN (012)

Certified Miles

Horny PI		0.06																													
AT RD/ST OFFSET MILES	TO ROAD NAME OFFSET MILES	LENGTH MILES (FEET)	OW' L	SURFACE		MAINT		CURB		SHOULDER		MEDIAN		ADT		ROW		FC	RC	SC	O	U/A	NHS	H	AC	ALN		INV	PVT		SW
				Type	WD	YR	Type	YR	P	LT	RT	LT	RT	TYPE	WD	I	CNT									YR	I		W	H	
Termini	Etiers Way	0.06 (317)	N 2	40	20	1982		4	0	0	000	000		E	000005	A	66	45	5	4	000	NON		00			2016	5	2015		

Jim Legge Dr		0.08																													
AT RD/ST OFFSET MILES	TO ROAD NAME OFFSET MILES	LENGTH MILES (FEET)	OW' L	SURFACE		MAINT		CURB		SHOULDER		MEDIAN		ADT		ROW		FC	RC	SC	O	U/A	NHS	H	AC	ALN		INV	PVT		SW
				Type	WD	YR	Type	YR	P	LT	RT	LT	RT	TYPE	WD	I	CNT									YR	I		W	H	
Etiers Way	Termini	0.08 (422)	N 2	50	20	2003		4	0	0	202	202	0	E	000000	E	66	45	5	4	000	NON		00		2016	3	2015			

Jones Ave		0.25																													
AT RD/ST OFFSET MILES	TO ROAD NAME OFFSET MILES	LENGTH MILES (FEET)	OW' L	SURFACE		MAINT		CURB		SHOULDER		MEDIAN		ADT		ROW		FC	RC	SC	O	U/A	NHS	H	AC	ALN		INV	PVT		SW
				Type	WD	YR	Type	YR	P	LT	RT	LT	RT	TYPE	WD	I	CNT									YR	I		W	H	
Ruby Dr	Collie Dr	0.25 (1319)	N 2	40	22	2005		3	0	0	104	104		E	000015	A	66	45	5	4	000	NON		00		2016	3	2015			

J Ziilinski Ln		0.50																													
AT RD/ST OFFSET MILES	TO ROAD NAME OFFSET MILES	LENGTH MILES (FEET)	OW' L	SURFACE		MAINT		CURB		SHOULDER		MEDIAN		ADT		ROW		FC	RC	SC	O	U/A	NHS	H	AC	ALN		INV	PVT		SW
				Type	WD	YR	Type	YR	P	LT	RT	LT	RT	TYPE	WD	I	CNT									YR	I		W	H	
40th St E	41st St	0.50 (2640)	N 1	45	12	1970		4	0	0	102	102		E	000015	E	66	45	5	4	000	NON		00		2016	6	2015			

Kayak Ct		0.13																													
AT RD/ST OFFSET MILES	TO ROAD NAME OFFSET MILES	LENGTH MILES (FEET)	OW' L	SURFACE		MAINT		CURB		SHOULDER		MEDIAN		ADT		ROW		FC	RC	SC	O	U/A	NHS	H	AC	ALN		INV	PVT		SW
				Type	WD	YR	Type	YR	P	LT	RT	LT	RT	TYPE	WD	I	CNT									YR	I		W	H	
Castaway Dr	Termini	0.11 (588)	N 2	70	20	2013		3			202	202		000000	A	66	45	5	4	000				00		2016	10	2015			

Lake Ct		0.07																													
AT RD/ST OFFSET MILES	TO ROAD NAME OFFSET MILES	LENGTH MILES (FEET)	OW' L	SURFACE		MAINT		CURB		SHOULDER		MEDIAN		ADT		ROW		FC	RC	SC	O	U/A	NHS	H	AC	ALN		INV	PVT		SW
				Type	WD	YR	Type	YR	P	LT	RT	LT	RT	TYPE	WD	I	CNT									YR	I		W	H	
Termini	N Lake Dr	0.07 (370)	N 2	35	12	1984		4	0	0	000	000		E	000005	E	66	45	5	4	000	NON		00		2016	4	2015			

**STATE OF WISCONSIN
DEPARTMENT OF TRANSPORTATION
WISCONSIN INFORMATION SYSTEM FOR LOCAL ROADS**
Inventory Listing With Maintenance (R-20)
1-1-2017 Certification

TOWN OF GERMANTOWN (012)

Rd/St Name

Certified Miles

N Lake Dr		0.32																														
AT RD/ST OFFSET MILES	TO ROAD NAME OFFSET MILES	LENGTH MILES (FEET)	OW	L	SURFACE		MAINT		CURB		SHOULDER		MEDIAN		ADT		ROW		FC	RC	SC	O	U/A	NHS	H	AC	ALN		INV	PVT		SW
					Type	WD	YR	Type	YR	P	LT	RT	LT	RT	Type	WD	I	CNT									YR	I		W	H	
STH 58	Lake Ct	0.24 (1267)	N	2	35	20	2004		4	0	0	203	203		E	000005		E	66	45	5	4	000	NON		00			2016	4	2015	
Lake Ct	Mallard Dr	0.08 (422)	N	2	35	20	2004		4	0	0	203	203		E	000005		E	66	45	5	4	000	NON		00			2016	4	2015	

S Lake Dr		0.32																														
AT RD/ST OFFSET MILES	TO ROAD NAME OFFSET MILES	LENGTH MILES (FEET)	OW	L	SURFACE		MAINT		CURB		SHOULDER		MEDIAN		ADT		ROW		FC	RC	SC	O	U/A	NHS	H	AC	ALN		INV	PVT		SW
					Type	WD	YR	Type	YR	P	LT	RT	LT	RT	Type	WD	I	CNT									YR	I		W	H	
Mallard Dr	STH 58	0.32 (1690)	N	2	35	20	2004		4	0	0	203	203		E	000005		E	66	45	5	4	000	NON		00			2016	4	2015	

Lake Rd		0.37																														
AT RD/ST OFFSET MILES	TO ROAD NAME OFFSET MILES	LENGTH MILES (FEET)	OW	L	SURFACE		MAINT		CURB		SHOULDER		MEDIAN		ADT		ROW		FC	RC	SC	O	U/A	NHS	H	AC	ALN		INV	PVT		SW
					Type	WD	YR	Type	YR	P	LT	RT	LT	RT	Type	WD	I	CNT									YR	I		W	H	
Termini	South Shore Rd	0.15 (792)	N	1	70	10	2003		4	0	0	102	102		E	000015		E	50	45	5	4	000	NON		00			2016	7	2015	
South Shore Rd	Trails' End Ct	0.09 (475)	N	2	70	20	2003		4	0	0	202	202	0	E	000015		E	50	45	5	4	000	NON		00			2016	7	2015	
Trails' End Ct	CTH G	0.12 (634)	N	2	70	20	2003			0	0	202	202	0		000000		E	60	45	5	4	000	NON		00			2016	7	2015	

Legend Lake Cir		0.15																														
AT RD/ST OFFSET MILES	TO ROAD NAME OFFSET MILES	LENGTH MILES (FEET)	OW	L	SURFACE		MAINT		CURB		SHOULDER		MEDIAN		ADT		ROW		FC	RC	SC	O	U/A	NHS	H	AC	ALN		INV	PVT		SW
					Type	WD	YR	Type	YR	P	LT	RT	LT	RT	Type	WD	I	CNT									YR	I		W	H	
Termini	Half Moon Bay Dr E	0.15 (792)	N	2	55	24	2008		3	0	0	202	202	0	E	000025		A	66	45	5	4	000	NON		00			2016	7	2015	

**STATE OF WISCONSIN
DEPARTMENT OF TRANSPORTATION
WISCONSIN INFORMATION SYSTEM FOR LOCAL ROADS**
Inventory Listing With Maintenance (R-20)
1-1-2017 Certification

TOWN OF GERMANTOWN (012)

Rd/St Name

Certified Miles

Lucey Ln		0.34																											
AT RD/ST OFFSET MILES	TO ROAD NAME OFFSET MILES	LENGTH MILES (FEET)	OW' L	SURFACE		MAINT	P	CURB SHOULDER		MEDIAN		ADT		ROW		FC	RC	SC	O	U/A	NHS	H	AC	ALN H V	INV YR	PVT		SW	
				Type	WD			YR	LT	RT	LT	RT	Type	WD	I											CNT	YR		I
	Termini	0.06 (317)	N 2	40	18	2008		4	0	0	103	103	E	000015	E	66	45	5		4	000	NON				2016	5	2015	
	Termini	0.12 (633)	N 2	40	22	2008		3	0	0	202	202	E	000015	E	66	45	5		4	000	NON				2014	5	2013	
	Termini (0.12)	0.06 (317)	N 2	40	22	2008		3	0	0	202	202	E	000015	E	66	45	5		4	000	NON				2014	5	2011	
	Ruth Ct	0.12 (634)	N 2	40	22	2008		3	0	0	202	202	E	000015	E	66	45	5		4	000	NON				2016	5	2015	

Mallard Dr		0.58																											
AT RD/ST OFFSET MILES	TO ROAD NAME OFFSET MILES	LENGTH MILES (FEET)	OW' L	SURFACE		MAINT	P	CURB SHOULDER		MEDIAN		ADT		ROW		FC	RC	SC	O	U/A	NHS	H	AC	ALN H V	INV YR	PVT		SW	
				Type	WD			YR	LT	RT	LT	RT	Type	WD	I											CNT	YR		I
	Whistling Wings Dr	0.08 (422)	N 2	40	20	2000		4	0	0	102	102	E	000015	E	66	45	5		4	000	NON				2016	4	2015	
	Quail Dr	0.07 (370)	N 2	40	20	2000		4	0	0	102	102	E	000015	E	66	45	5		4	000	NON				2016	4	2015	
	Pheasant Dr	0.05 (264)	N 2	40	20	2000		4	0	0	102	102	E	000015	E	66	45	5		4	000	NON				2016	4	2015	
	Tomahawk Trl	0.21 (1109)	N 1	40	10	1971		4	0	0	102	102	E	000015	E	66	45	5		4	000	NON				2016	4	2015	
	Running Bear Trl	0.04 (211)	N 1	40	10	1971		4	0	0	102	102	E	000015	E	66	45	5		4	000	NON				2016	4	2015	
	N Lake Dr	0.13 (686)	N 2	35	20	2004		4	0	0	203	203	E	000005	E	66	45	5		4	000	NON				2016	4	2015	

May's Point Rd		0.67																											
AT RD/ST OFFSET MILES	TO ROAD NAME OFFSET MILES	LENGTH MILES (FEET)	OW' L	SURFACE		MAINT	P	CURB SHOULDER		MEDIAN		ADT		ROW		FC	RC	SC	O	U/A	NHS	H	AC	ALN H V	INV YR	PVT		SW	
				Type	WD			YR	LT	RT	LT	RT	Type	WD	I											CNT	YR		I
	29th St E	0.30 (1584)	N 2	70	20	2004		4	0	0	203	203	A	000000	A	66	45	5		4	000	NON				2016	8	2015	
	22nd Ave	0.37 (1954)	N 2	70	20	2004		4	0	0	203	203	A	000000	A	66	45	5		4	000	NON				2016	8	2015	

STATE OF WISCONSIN
 DEPARTMENT OF TRANSPORTATION
 WISCONSIN INFORMATION SYSTEM FOR LOCAL ROADS
 Inventory Listing With Maintenance (R-20)
 1-1-2017 Certification

TOWN OF GERMANTOWN (012)

Certified Miles

Meadow Ct		0.15																												
AT RD/ST OFFSET MILES	TO ROAD NAME OFFSET MILES	LENGTH MILES (FEET)	OW' L	SURFACE		MAINT	P	CURB		SHOULDER		MEDIAN		ADT		ROW	FC	RC	SC	O	U/A	NHS	H	AC	ALN		INV	PVT		SW
				Type	WD			YR	1997	4	0	0	000	000	000										E	000015		E	66	
Meadow Dr	Termini	0.15 (792)	N 2	55	22	1997		4	0	0	000	000			E	000015	E	66	45	5	4	000	NON	00			2016	7	2015	

Meadow Dr		0.36																												
AT RD/ST OFFSET MILES	TO ROAD NAME OFFSET MILES	LENGTH MILES (FEET)	OW' L	SURFACE		MAINT	P	CURB		SHOULDER		MEDIAN		ADT		ROW	FC	RC	SC	O	U/A	NHS	H	AC	ALN		INV	PVT		SW
				Type	WD			YR	2002	3	0	0	202	202											E	000015		E	66	
Cherokee Ln	Meadow Ct	0.16 (845)	N 2	70	22	2002		3	0	0	202	202			E	000015	E	66	45	5	4	000	NON	00			2016	7	2015	
Meadow Ct	Half Moon Bay Dr W	0.21 (1109)	N 2	40	24	2006		3	0	0	202	202	0	0	E	000015	E	66	45	5	4	000	NON	00			2016	4	2015	

Nordall Ln		0.20																												
AT RD/ST OFFSET MILES	TO ROAD NAME OFFSET MILES	LENGTH MILES (FEET)	OW' L	SURFACE		MAINT	P	CURB		SHOULDER		MEDIAN		ADT		ROW	FC	RC	SC	O	U/A	NHS	H	AC	ALN		INV	PVT		SW
				Type	WD			YR	1979 <td>4</td> <td>0</td> <td>0</td> <td>000</td> <td>000</td> <td></td> <td>E</td> <td>000015</td> <td>E</td> <td>66</td> <td>45</td> <td>5</td> <td>4</td> <td>000</td> <td>NON</td> <td>00</td> <td></td> <td></td> <td>2016</td> <td>3</td> <td>2015</td>	4	0	0	000	000											E	000015		E	66	
Sawyer Rd	CTH G	0.20 (1056)	N 2	40	22	1979		4	0	0	000	000			E	000015	E	66	45	5	4	000	NON	00			2016	3	2015	

Northface Cir		0.11																												
AT RD/ST OFFSET MILES	TO ROAD NAME OFFSET MILES	LENGTH MILES (FEET)	OW' L	SURFACE		MAINT	P	CURB		SHOULDER		MEDIAN		ADT		ROW	FC	RC	SC	O	U/A	NHS	H	AC	ALN		INV	PVT		SW
				Type	WD			YR	2008 <td></td> <td></td> <td>204</td> <td>204</td> <td></td> <td></td> <td>000000</td> <td>A</td> <td>66</td> <td>45</td> <td>5</td> <td>4</td> <td>000</td> <td>NON</td> <td>00</td> <td></td> <td></td> <td>2016</td> <td>9</td> <td>2015</td>			204	204												000000	A		66	45	
North Shore Dr	North Shore Dr	0.12 (609)	N 2	70	20	2008					204	204			000000	A	66	45	5	4	000	NON	00			2016	9	2015		

STATE OF WISCONSIN
DEPARTMENT OF TRANSPORTATION
WISCONSIN INFORMATION SYSTEM FOR LOCAL ROADS

Inventory Listing With Maintenance (R-20)
1-1-2017 Certification

TOWN OF GERMANTOWN (012)

Certified Miles

Rd/St Name		1.25																												
AT RD/ST OFFSET MILES	TO ROAD NAME OFFSET MILES	LENGTH MILES (FEET)	OW' L	SURFACE		MAINT	P	CURB		SHOULDER		MEDIAN		ADT		ROW	FC	RC	SC	O	U/A	NHS	H	AC	ALN	INV	PVT		SW	
				Type	WD			YR	LT	RT	LT	RT	TYPE	WD	I												CNT	YR		I
15th Ave	Copper Point Dr	0.21 (1089)	N 2	70	22	2005				204	204			000000		A	66	45	5		4	000	NON				2016	10	2015	
Copper Point Dr	Windover Ct (0.15)	0.15 (812)	N 2	70	22	2005				204	204			000000		A	66	45	5		4	000	NON				2016	10	2015	
Copper Point Dr (0.15)	Windover Ct	0.07 (360)	N 2	70	20	2008				204	204			000000		A	66	45	5		4	000	NON				2016	10	2015	
Windover Ct	Northface Cir	0.22 (1176)	N 2	70	20	2008				204	204			000000		A	66	45	5		4	000	NON				2016	10	2015	
Northface Cir	Northface Cir	0.04 (204)	N 2	70	20	2008				204	204			000000		A	66	45	5		4	000	NON				2016	9	2015	
Northface Cir	Copper Point Dr	0.41 (2140)	N 2	70	20	2008				204	204			000000		A	66	45	5		4	000	NON				2016	9	2015	
Copper Point Dr	CTH G	0.06 (317)	N 2	70	20	2008				204	204			000000		A	66	45	5		4	000	NON				2016	9	2015	
CTH G	Castaway Dr	0.04 (188)	N 2	70	20	2013				202	202			000000		A	66	45	5		4	000					2016	10	2015	

Oak Hollow Trl		0.43																												
AT RD/ST OFFSET MILES	TO ROAD NAME OFFSET MILES	LENGTH MILES (FEET)	OW' L	SURFACE		MAINT	P	CURB		SHOULDER		MEDIAN		ADT		ROW	FC	RC	SC	O	U/A	NHS	H	AC	ALN	INV	PVT		SW	
				Type	WD			YR	LT	RT	LT	RT	TYPE	WD	I												CNT	YR		I
Beach Dr	Termini	0.43 (2270)	N 2	45	22	2002		4	0	0	103	103	0	0	000000	E	66	45	5		4	000	NON				2016	4	2015	

Oakwood Ln		0.06																												
AT RD/ST OFFSET MILES	TO ROAD NAME OFFSET MILES	LENGTH MILES (FEET)	OW' L	SURFACE		MAINT	P	CURB		SHOULDER		MEDIAN		ADT		ROW	FC	RC	SC	O	U/A	NHS	H	AC	ALN	INV	PVT		SW	
				Type	WD			YR	LT	RT	LT	RT	TYPE	WD	I												CNT	YR		I
CTH G	Evergreen Ln	0.06 (317)	N 2	40	18	1986		4	0	0	000	000		E	000050	E	66	45	5		4	000	NON				2016	3	2015	

Osprey Ct		0.07																												
AT RD/ST OFFSET MILES	TO ROAD NAME OFFSET MILES	LENGTH MILES (FEET)	OW' L	SURFACE		MAINT	P	CURB		SHOULDER		MEDIAN		ADT		ROW	FC	RC	SC	O	U/A	NHS	H	AC	ALN	INV	PVT		SW	
				Type	WD			YR	LT	RT	LT	RT	TYPE	WD	I												CNT	YR		I
N Osprey Dr	N Osprey Dr	0.07 (370)	N 2	57	22	1990		4	0	0	202	202		E	000005	A	66	45	5		4	000	NON				2016	7	2015	

STATE OF WISCONSIN
 DEPARTMENT OF TRANSPORTATION
 WISCONSIN INFORMATION SYSTEM FOR LOCAL ROADS
 Inventory Listing With Maintenance (R-20)
 1-1-2017 Certification

TOWN OF GERMANTOWN (012)

Certified Miles

N Osprey Dr		0.58																												
AT RD/ST OFFSET MILES	TO ROAD NAME OFFSET MILES	LENGTH MILES (FEET)	OW L	SURFACE		MAINT		CURB		SHOULDER		MEDIAN		ADT		ROW		FC	RC	SC	O	U/A	NHS	H	AC	ALN H V	INV YR	PVT		SW
				Type	WD	YR	Type	YR	P	LT	RT	LT	RT	Type	WD	I	CNT											YR	I	
17th Ave	S Osprey Dr	0.04 (211)	N 2	57	22	2002		3	0	0	000	000		E	000015	2002	A	66	45	5	4	000	NON		00		2016	7	2015	
S Osprey Dr	Osprey Ct	0.35 (1848)	N 2	57	22	2002		3	0	0	000	000		E	000015	2002	A	66	45	5	4	000	NON		00		2016	7	2015	
Osprey Ct	Osprey Ct	0.03 (158)	N 2	57	22	1990		4	0	0	202	202		E	000175		A	66	45	5	4	000	NON		00		2016	7	2015	
Osprey Ct	S Osprey Dr	0.16 (845)	N 2	57	22	2002		3	0	0	000	000		E	000015	2002	A	66	45	5	4	000	NON		00		2016	7	2015	

S Osprey Dr		0.39																												
AT RD/ST OFFSET MILES	TO ROAD NAME OFFSET MILES	LENGTH MILES (FEET)	OW L	SURFACE		MAINT		CURB		SHOULDER		MEDIAN		ADT		ROW		FC	RC	SC	O	U/A	NHS	H	AC	ALN H V	INV YR	PVT		SW
				Type	WD	YR	Type	YR	P	LT	RT	LT	RT	Type	WD	I	CNT											YR	I	
N Osprey Dr	N Osprey Dr	0.39 (2059)	N 2	57	22	2002		3	0	0	000	000		E	000015	2002	A	66	45	5	4	000	NON		00		2016	7	2015	

Osprey Rd		0.05																												
AT RD/ST OFFSET MILES	TO ROAD NAME OFFSET MILES	LENGTH MILES (FEET)	OW L	SURFACE		MAINT		CURB		SHOULDER		MEDIAN		ADT		ROW		FC	RC	SC	O	U/A	NHS	H	AC	ALN H V	INV YR	PVT		SW
				Type	WD	YR	Type	YR	P	LT	RT	LT	RT	Type	WD	I	CNT											YR	I	
N Osprey Dr	Termini	0.05 (264)	N 2	57	22	1990		4	0	0	202	202		E	000005		A	66	45	5	4	000	NON		00		2016	7	2015	

Park Place Dr		0.99																												
AT RD/ST OFFSET MILES	TO ROAD NAME OFFSET MILES	LENGTH MILES (FEET)	OW L	SURFACE		MAINT		CURB		SHOULDER		MEDIAN		ADT		ROW		FC	RC	SC	O	U/A	NHS	H	AC	ALN H V	INV YR	PVT		SW
				Type	WD	YR	Type	YR	P	LT	RT	LT	RT	Type	WD	I	CNT											YR	I	
CTH G	Unknown	0.03 (158)	N 2	40	22	2005		3	0	0	102	102	0	0	000000		A	66	45	5	4	000	NON		00		2016	4	2015	
Unknown	Unknown	0.96 (5070)	N 2	40	22	2005		3	0	0	102	102	0	0	000000		A	66	45	5	4	000	NON		00		2016	4	2015	

Petras Ln		0.47																												
AT RD/ST OFFSET MILES	TO ROAD NAME OFFSET MILES	LENGTH MILES (FEET)	OW L	SURFACE		MAINT		CURB		SHOULDER		MEDIAN		ADT		ROW		FC	RC	SC	O	U/A	NHS	H	AC	ALN H V	INV YR	PVT		SW
				Type	WD	YR	Type	YR	P	LT	RT	LT	RT	Type	WD	I	CNT											YR	I	
CTH G	40th St E	0.47 (2482)	N 2	55	20	2002		3	0	0	201	201		E	000015	2002	E	50	45	5	4	000	NON		00		2016	5	2015	

**STATE OF WISCONSIN
DEPARTMENT OF TRANSPORTATION
WISCONSIN INFORMATION SYSTEM FOR LOCAL ROADS**
Inventory Listing With Maintenance (R-20)
1-1-2017 Certification

TOWN OF GERMANTOWN (012)

Rd/St Name Certified Miles

Pheasant Dr		0.41																									
AT RD/ST OFFSET MILES	TO ROAD NAME OFFSET MILES	LENGTH MILES (FEET)	OW L	SURFACE		MAINT	P	CURB SHOULDER		MEDIAN	ADT		ROW		FC	RC	SC	O U/A	NHS	H	AC	ALN		INV	PVT		SW
				Type	WD YR			LT	RT		LT	RT	Type	WD								I	CNT		YR	I	
	Deer Path	0.41 (2165)	N 2 40	20	2000		4	0	0	102	102	E	000015	E	66	45	5	4	000	NON		00		2016	4	2015	

Pine Ln		0.51																									
AT RD/ST OFFSET MILES	TO ROAD NAME OFFSET MILES	LENGTH MILES (FEET)	OW L	SURFACE		MAINT	P	CURB SHOULDER		MEDIAN	ADT		ROW		FC	RC	SC	O U/A	NHS	H	AC	ALN		INV	PVT		SW
				Type	WD YR			LT	RT		LT	RT	Type	WD								I	CNT		YR	I	
	Timber Trl	0.07 (370)	N 2 40	22	2005		3	0	0	000	000	E	000015	A	66	45	5	4	000	NON		00		2016	4	2015	
	Timber Trl	0.44 (2323)	N 2 40	22	2005	3	2012	3	0	000	000	E	000015	A	66	45	5	4	000	NON		00		2016	4	2015	

Poplar Ln		0.27																									
AT RD/ST OFFSET MILES	TO ROAD NAME OFFSET MILES	LENGTH MILES (FEET)	OW L	SURFACE		MAINT	P	CURB SHOULDER		MEDIAN	ADT		ROW		FC	RC	SC	O U/A	NHS	H	AC	ALN		INV	PVT		SW
				Type	WD YR			LT	RT		LT	RT	Type	WD								I	CNT		YR	I	
	Woodland Trl	0.27 (1426)	N 2 40	22	2005		3	0	0	000	000	E	000015	A	66	45	5	4	000	NON		00		2016	4	2015	

Presnell Ct		0.07																									
AT RD/ST OFFSET MILES	TO ROAD NAME OFFSET MILES	LENGTH MILES (FEET)	OW L	SURFACE		MAINT	P	CURB SHOULDER		MEDIAN	ADT		ROW		FC	RC	SC	O U/A	NHS	H	AC	ALN		INV	PVT		SW
				Type	WD YR			LT	RT		LT	RT	Type	WD								I	CNT		YR	I	
	Eiters Way	0.07 (370)	N 2 40	22	2000		4	0	0	000	000	E	000005	A	66	45	5	4	000	NON		00		2016	3	2015	

Quail Dr		0.45																									
AT RD/ST OFFSET MILES	TO ROAD NAME OFFSET MILES	LENGTH MILES (FEET)	OW L	SURFACE		MAINT	P	CURB SHOULDER		MEDIAN	ADT		ROW		FC	RC	SC	O U/A	NHS	H	AC	ALN		INV	PVT		SW
				Type	WD YR			LT	RT		LT	RT	Type	WD								I	CNT		YR	I	
	Deer Path	0.45 (2376)	N 2 40	20	1999		4	0	0	000	000	E	000015	E	66	45	5	4	000	NON		00		2016	4	2015	

Quiet Water Ct		0.08																									
AT RD/ST OFFSET MILES	TO ROAD NAME OFFSET MILES	LENGTH MILES (FEET)	OW L	SURFACE		MAINT	P	CURB SHOULDER		MEDIAN	ADT		ROW		FC	RC	SC	O U/A	NHS	H	AC	ALN		INV	PVT		SW
				Type	WD YR			LT	RT		LT	RT	Type	WD								I	CNT		YR	I	
	Termini	0.07 (351)	N 2 70	20	2008							000000	A	66	45	5	4	000	NON		00		2016	10	2015		

**STATE OF WISCONSIN
DEPARTMENT OF TRANSPORTATION
WISCONSIN INFORMATION SYSTEM FOR LOCAL ROADS**
Inventory Listing With Maintenance (R-20)
1-1-2017 Certification

TOWN OF GERMANTOWN (012)

Rd/St Name Certified Miles

Raven Ct		0.07																									
AT RD/ST OFFSET MILES	TO ROAD NAME OFFSET MILES	LENGTH MILES (FEET)	OW L	SURFACE		MAINT		CURB SHOULDER		MEDIAN	ADT		ROW		FC	RC	SC	O U/A	NHS	H AC	ALN		INV YR	PVT		SW	
				Type	WD YR	Type	YR	P	LT		RT	LT	RT	Type							WD	I		CNT	YR		I
	Termini	0.07 (370)	N 2	57	20	2004		4	0	0	202	202	0	0	000000	A	66	45	5	4	000	NON	00	2016	7	2015	

Raven Dr		0.41																									
AT RD/ST OFFSET MILES	TO ROAD NAME OFFSET MILES	LENGTH MILES (FEET)	OW L	SURFACE		MAINT		CURB SHOULDER		MEDIAN	ADT		ROW		FC	RC	SC	O U/A	NHS	H AC	ALN		INV YR	PVT		SW	
				Type	WD YR	Type	YR	P	LT		RT	LT	RT	Type							WD	I		CNT	YR		I
	Raven Ct	0.16 (845)	N 2	40	20	2004		4	0	0	201	201		E	000015	E	66	45	5	4	000	NON	00	2016	4	2015	
	Whistling Wings Dr	0.25 (1320)	N 2	40	20	2004		4	0	0	201	201		E	000015	E	66	45	5	4	000	NON	00	2016	4	2015	

Red Oak Ct		0.03																									
AT RD/ST OFFSET MILES	TO ROAD NAME OFFSET MILES	LENGTH MILES (FEET)	OW L	SURFACE		MAINT		CURB SHOULDER		MEDIAN	ADT		ROW		FC	RC	SC	O U/A	NHS	H AC	ALN		INV YR	PVT		SW	
				Type	WD YR	Type	YR	P	LT		RT	LT	RT	Type							WD	I		CNT	YR		I
	Termini	0.03 (158)	N 1	50	22	2007		3	0	0	202	202		E	000015	E	60	45	5	4	000	NON	00	2016	8	2015	

Red Pine Dr		0.15																									
AT RD/ST OFFSET MILES	TO ROAD NAME OFFSET MILES	LENGTH MILES (FEET)	OW L	SURFACE		MAINT		CURB SHOULDER		MEDIAN	ADT		ROW		FC	RC	SC	O U/A	NHS	H AC	ALN		INV YR	PVT		SW	
				Type	WD YR	Type	YR	P	LT		RT	LT	RT	Type							WD	I		CNT	YR		I
	Termini	0.15 (792)	N 2	70	20	2004		4	0	0	203	203	0	0	000000	A	66	45	5	4	000	NON	00	2016	8	2015	

Ridgewater Dr		0.35																									
AT RD/ST OFFSET MILES	TO ROAD NAME OFFSET MILES	LENGTH MILES (FEET)	OW L	SURFACE		MAINT		CURB SHOULDER		MEDIAN	ADT		ROW		FC	RC	SC	O U/A	NHS	H AC	ALN		INV YR	PVT		SW	
				Type	WD YR	Type	YR	P	LT		RT	LT	RT	Type							WD	I		CNT	YR		I
	Termini	0.27 (1426)	N 2	70	22	2005					204	204			000000	A	66	45	5	4	000	NON	00	2016	7	2015	

Rising Sun Ct		0.11																									
AT RD/ST OFFSET MILES	TO ROAD NAME OFFSET MILES	LENGTH MILES (FEET)	OW L	SURFACE		MAINT		CURB SHOULDER		MEDIAN	ADT		ROW		FC	RC	SC	O U/A	NHS	H AC	ALN		INV YR	PVT		SW	
				Type	WD YR	Type	YR	P	LT		RT	LT	RT	Type							WD	I		CNT	YR		I
	Termini	0.10 (535)	N 2	70	20	2008					204	204			000000	A	66	45	5	4	000	NON	00	2016	8	2015	

STATE OF WISCONSIN
 DEPARTMENT OF TRANSPORTATION
 WISCONSIN INFORMATION SYSTEM FOR LOCAL ROADS
 Inventory Listing With Maintenance (R-20)
 1-1-2017 Certification

TOWN OF GERMANTOWN (012)

Rd/St Name **Certified Miles**

Rivers Edge Rd		0.19																												
AT RD/ST OFFSET MILES	TO ROAD NAME OFFSET MILES	LENGTH MILES (FEET)	OW' L	SURFACE		MAINT		CURB		SHOULDER		MEDIAN		ADT		ROW		FC	RC	SC	O	U/A	NHS	H	AC	ALN H V	INV YR	PVT		SW
				Type	WD	YR	Type	YR	P	LT	RT	LT	RT	Type	WD	I	CNT											YR	I	
CTH G	Shimmering Waters Dr	0.19 (1003)	N 2	70	22	2005					204	204			000000	A	66	45	5		4	000	NON		00		2016	10	2015	

Ruby Dr		0.17																												
AT RD/ST OFFSET MILES	TO ROAD NAME OFFSET MILES	LENGTH MILES (FEET)	OW' L	SURFACE		MAINT		CURB		SHOULDER		MEDIAN		ADT		ROW		FC	RC	SC	O	U/A	NHS	H	AC	ALN H V	INV YR	PVT		SW
				Type	WD	YR	Type	YR	P	LT	RT	LT	RT	Type	WD	I	CNT											YR	I	
17th Ave	Jones Ave	0.17 (898)	N 2	40	22	2005			3	0	104	104		E	000015	A	66	45	5		4	000	NON		00		2016	4	2015	

Running Bear Trl		0.28																												
AT RD/ST OFFSET MILES	TO ROAD NAME OFFSET MILES	LENGTH MILES (FEET)	OW' L	SURFACE		MAINT		CURB		SHOULDER		MEDIAN		ADT		ROW		FC	RC	SC	O	U/A	NHS	H	AC	ALN H V	INV YR	PVT		SW
				Type	WD	YR	Type	YR	P	LT	RT	LT	RT	Type	WD	I	CNT											YR	I	
Tomahawk Trl	Mallard Dr	0.28 (1478)	N 1	40	10	2008			3	0	202	202		E	000015	E	66	45	5		4	000	NON		00		2016	4	2015	

Ruth Ct		0.09																												
AT RD/ST OFFSET MILES	TO ROAD NAME OFFSET MILES	LENGTH MILES (FEET)	OW' L	SURFACE		MAINT		CURB		SHOULDER		MEDIAN		ADT		ROW		FC	RC	SC	O	U/A	NHS	H	AC	ALN H V	INV YR	PVT		SW
				Type	WD	YR	Type	YR	P	LT	RT	LT	RT	Type	WD	I	CNT											YR	I	
Lucey Ln	Termini	0.09 (475)	N 2	40	20	2008			3	0	202	202		E	000015	E	66	45	5		4	000	NON		00		2016	4	2015	

Sandstone Dr		0.58																												
AT RD/ST OFFSET MILES	TO ROAD NAME OFFSET MILES	LENGTH MILES (FEET)	OW' L	SURFACE		MAINT		CURB		SHOULDER		MEDIAN		ADT		ROW		FC	RC	SC	O	U/A	NHS	H	AC	ALN H V	INV YR	PVT		SW
				Type	WD	YR	Type	YR	P	LT	RT	LT	RT	Type	WD	I	CNT											YR	I	
CTH G	Termini	0.05 (264)	N 2	40	20	1995			4	0	101	101		E	000015	A	66	45	5		4	000	NON		00		2016	3	2015	
Termini	Termini	0.53 (2798)	N 2	40	20	1995			4	0	101	101		E	000015	A	66	45	5		4	000	NON		00		2016	3	2015	

STATE OF WISCONSIN
 DEPARTMENT OF TRANSPORTATION
 WISCONSIN INFORMATION SYSTEM FOR LOCAL ROADS
 Inventory Listing With Maintenance (R-20)
 1-1-2017 Certification

TOWN OF GERMANTOWN (012)

Certified Miles

Sawyer Rd		0.25																											
AT RD/ST OFFSET MILES	TO ROAD NAME OFFSET MILES	LENGTH MILES (FEET)	OW L	SURFACE		MAINT	P	CURB SHOULDER		MEDIAN	ADT		ROW		FC	RC	SC	O	U/A	NHS	H	AC	ALN		INV	PVT		SW	
				Type	WD			YR	LT		RT	LT	RT	Type									WD	I		CNT	YR		I
	Nordall Ln	0.18 (950)	N 2	40	20	2009		3	0	0	000	000	E	000015	E	66	45	5	4	000	NON	00				2016	3	2015	
	Nordall Ln	0.07 (370)	N 2	40	20	2009		3	0	0	000	000	E	000015	E	66	45	5	4	000	NON	00			2016	3	2015		

Setting Sun Ct

Setting Sun Ct		0.04																										
AT RD/ST OFFSET MILES	TO ROAD NAME OFFSET MILES	LENGTH MILES (FEET)	OW L	SURFACE		MAINT	P	CURB SHOULDER		MEDIAN	ADT		ROW		FC	RC	SC	O	U/A	NHS	H	AC	ALN		INV	PVT		SW
				Type	WD			YR	LT		RT	LT	RT	Type									WD	I		CNT	YR	
	Termini	0.04 (188)	N 2	70	20	2008									A	66	45	5	4	000	NON	00			2016	10	2015	

Shacks Rd

Shacks Rd		0.62																										
AT RD/ST OFFSET MILES	TO ROAD NAME OFFSET MILES	LENGTH MILES (FEET)	OW L	SURFACE		MAINT	P	CURB SHOULDER		MEDIAN	ADT		ROW		FC	RC	SC	O	U/A	NHS	H	AC	ALN		INV	PVT		SW
				Type	WD			YR	LT		RT	LT	RT	Type									WD	I		CNT	YR	
	Termini	0.06 (333)	N 2	40	20	2002		3	0	0	000	000	E	000015	E	66	45	5	4	000	NON	00			2016	4	2015	
	Timber Ridge Ln	0.56 (2941)	N 2	40	20	2002		3	0	0	000	000	E	000015	E	66	45	5	4	000	NON	00			2016	4	2015	

Shimmering Waters Dr

Shimmering Waters Dr		0.22																										
AT RD/ST OFFSET MILES	TO ROAD NAME OFFSET MILES	LENGTH MILES (FEET)	OW L	SURFACE		MAINT	P	CURB SHOULDER		MEDIAN	ADT		ROW		FC	RC	SC	O	U/A	NHS	H	AC	ALN		INV	PVT		SW
				Type	WD			YR	LT		RT	LT	RT	Type									WD	I		CNT	YR	
	CTH G	0.07 (350)	N 2	70	22	2005								A	66	45	5	4	000	NON	00			2016	10	2015		
	Rivers Edge Rd	0.10 (548)	N 2	70	22	2005								A	66	45	5	4	000	NON	00			2016	10	2015		

E Side Ct

E Side Ct		0.07																										
AT RD/ST OFFSET MILES	TO ROAD NAME OFFSET MILES	LENGTH MILES (FEET)	OW L	SURFACE		MAINT	P	CURB SHOULDER		MEDIAN	ADT		ROW		FC	RC	SC	O	U/A	NHS	H	AC	ALN		INV	PVT		SW
				Type	WD			YR	LT		RT	LT	RT	Type									WD	I		CNT	YR	
	Big Oak Dr	0.07 (370)	N 2	70	20	2007		3	0	0	202	202	E	000015	E	60	45	5	4	000	NON	00			2016	10	2015	

STATE OF WISCONSIN
DEPARTMENT OF TRANSPORTATION
WISCONSIN INFORMATION SYSTEM FOR LOCAL ROADS

Inventory Listing With Maintenance (R-20)
1-1-2017 Certification

TOWN OF GERMANTOWN (012)

Certified Miles

Silver Canoe Ct		0.13																												
AT RD/ST OFFSET MILES	TO ROAD NAME OFFSET MILES	LENGTH MILES (FEET)	OW L	SURFACE		MAINT	P	CURB		SHOULDER		MEDIAN		ADT		ROW		FC	RC	SC	O	U/A	NHS	H	AC	ALN H V	INV YR	PVT		SW
				Type	WD			YR	20	2008	LT	RT	LT	RT	TYPE	WD	I											CNT	YR	
S Stone Gate Dr	Termini	0.11 (593)	N 2	70	20	2008					204	204			000000	A	66	45	5	4	000	NON		00		2016	10	2015		

Sioux Ln		0.25																												
AT RD/ST OFFSET MILES	TO ROAD NAME OFFSET MILES	LENGTH MILES (FEET)	OW L	SURFACE		MAINT	P	CURB		SHOULDER		MEDIAN		ADT		ROW		FC	RC	SC	O	U/A	NHS	H	AC	ALN H V	INV YR	PVT		SW
				Type	WD			YR	21	2008	LT	RT	LT	RT	TYPE	WD	I											CNT	YR	
Apache Ln	Apache Ln	0.25 (1320)	N 2	40	21	2008	3	0	0	202	202			E 000015	E	66	45	5	4	000	NON		00		2016	5	2015			

South Shore Rd		0.45																												
AT RD/ST OFFSET MILES	TO ROAD NAME OFFSET MILES	LENGTH MILES (FEET)	OW L	SURFACE		MAINT	P	CURB		SHOULDER		MEDIAN		ADT		ROW		FC	RC	SC	O	U/A	NHS	H	AC	ALN H V	INV YR	PVT		SW
				Type	WD			YR	20 <th>2003</th> <th>LT</th> <th>RT</th> <th>LT</th> <th>RT</th> <th>TYPE</th> <th>WD</th> <th>I</th> <th>CNT</th> <th>YR</th> <th>I</th> <th>W</th> <th>R</th> <th>YR</th>	2003	LT	RT	LT	RT	TYPE	WD	I											CNT	YR	
Lake Rd	High Ridge Rd	0.32 (1690)	N 2	70	20	2003	4	0	0	202	202	0	0	000000	A	66	45	5	4	000	NON		00		2016	10	2015			
High Ridge Rd	Termini	0.13 (686)	N 2	70	20	2003	4	0	0	202	202	0	0	000000	A	66	45	5	4	000	NON		00		2016	10	2015			

N Stone Gate Dr		0.58																												
AT RD/ST OFFSET MILES	TO ROAD NAME OFFSET MILES	LENGTH MILES (FEET)	OW L	SURFACE		MAINT	P	CURB		SHOULDER		MEDIAN		ADT		ROW		FC	RC	SC	O	U/A	NHS	H	AC	ALN H V	INV YR	PVT		SW
				Type	WD			YR	20 <th>2008</th> <th>LT</th> <th>RT</th> <th>LT</th> <th>RT</th> <th>TYPE</th> <th>WD</th> <th>I</th> <th>CNT</th> <th>YR</th> <th>I</th> <th>W</th> <th>R</th> <th>YR</th>	2008	LT	RT	LT	RT	TYPE	WD	I											CNT	YR	
15th Ave	Blue Water Ct	0.26 (1351)	N 2	70	20	2008				204	204			000000	A	66	45	5	4	000	NON		00		2016	10	2015			
Blue Water Ct	37th St E	0.33 (1724)	N 2	70	20	2008				204	204			000000	A	66	45	5	4	000	NON		00		2016	10	2015			

STATE OF WISCONSIN
 DEPARTMENT OF TRANSPORTATION
 WISCONSIN INFORMATION SYSTEM FOR LOCAL ROADS
 Inventory Listing With Maintenance (R-20)
 1-1-2017 Certification

TOWN OF GERMANTOWN (012)

Certified Miles

S Stone Gate Dr		1.29																												
AT RD/ST OFFSET MILES	TO ROAD NAME OFFSET MILES	LENGTH MILES (FEET)	OW L	SURFACE		MAINT P	CURB		SHOULDER		MEDIAN		ADT		ROW		FC	RC	SC	O	U/A	NHS	H	AC	ALN		INV YR	PVT		SW
				Type	WD		YR	LT	RT	LT	RT	TYPE	WD	I	CNT	YR									I	W		H	V	
	Silver Canoe Ct	0.17 (897)	N 2	70	20	2008				204	204			000000		A	66	45	5	4	000	NON		00			2016	10	2015	
	Quiet Water Ct	0.17 (872)	N 2	70	20	2008				204	204			000000		A	66	45	5	4	000	NON		00			2016	10	2015	
	Setting Sun Ct	0.45 (2359)	N 2	70	20	2008				204	204			000000		A	66	45	5	4	000	NON		00			2016	10	2015	
	Setting Sun Ct	0.50 (2616)	N 2	70	20	2008				204	204			000000		A	66	45	5	4	000	NON		00			2016	10	2015	

Sullivan's Ln		0.12																												
AT RD/ST OFFSET MILES	TO ROAD NAME OFFSET MILES	LENGTH MILES (FEET)	OW L	SURFACE		MAINT P	CURB		SHOULDER		MEDIAN		ADT		ROW		FC	RC	SC	O	U/A	NHS	H	AC	ALN		INV YR	PVT		SW
				Type	WD		YR	LT	RT	LT	RT	TYPE	WD	I	CNT	YR									I	W		H	V	
	Alice Ln	0.12 (634)	N 2	40	18	2009	4	0	0	103	103			E 000015		A	66	45	5	4	000	NON		00			2016	3	2015	

Sunny Ln		0.25																												
AT RD/ST OFFSET MILES	TO ROAD NAME OFFSET MILES	LENGTH MILES (FEET)	OW L	SURFACE		MAINT P	CURB		SHOULDER		MEDIAN		ADT		ROW		FC	RC	SC	O	U/A	NHS	H	AC	ALN		INV YR	PVT		SW
				Type	WD		YR	LT	RT	LT	RT	TYPE	WD	I	CNT	YR									I	W		H	V	
	Termini	0.25 (1320)	N 2	40	22	2010	4	0	0	102	102			E 000015		E	66	45	5	4	000	NON		00			2016	5	2015	

Timber Ridge Ln		0.17																												
AT RD/ST OFFSET MILES	TO ROAD NAME OFFSET MILES	LENGTH MILES (FEET)	OW L	SURFACE		MAINT P	CURB		SHOULDER		MEDIAN		ADT		ROW		FC	RC	SC	O	U/A	NHS	H	AC	ALN		INV YR	PVT		SW
				Type	WD		YR	LT	RT	LT	RT	TYPE	WD	I	CNT	YR									I	W		H	V	
	Termini	0.17 (898)	N 2	70	22	2004	4	0	0	203	203	0	0	000000		A	66	45	5	4	000	NON		00			2016	10	2015	

STATE OF WISCONSIN
 DEPARTMENT OF TRANSPORTATION
 WISCONSIN INFORMATION SYSTEM FOR LOCAL ROADS
 Inventory Listing With Maintenance (R-20)
 1-1-2017 Certification

TOWN OF GERMANTOWN (012)

Certified Miles

Timber Trl		0.84																													
AT RD/ST OFFSET MILES	TO ROAD NAME OFFSET MILES	LENGTH MILES (FEET)	OW L	SURFACE		MAINT	P	CURB		SHOULDER		MEDIAN		ADT		ROW		FC	RC	SC	O	U/A	NHS	H	AC	ALN		INV	PVT		SW
				Type	WD			YR	LT	RT	LT	RT	TYPE	WD	I	CNT	YR									I	W		H	V	
Beach Dr	Pine Ln	0.28 (1478)	N 2	40	21	2006	3	0	0	102	202	0	0	E	000015	A	66	45	5	4	000	NON	00					2016	5	2015	
Pine Ln	Pine Ln	0.47 (2482)	N 2	40	21	2006	3	0	0	102	202	0	0	E	000015	A	66	45	5	4	000	NON	00				2016	5	2015		
Pine Ln	Beach Dr	0.09 (475)	N 2	40	21	2006	3	0	0	102	202	0	0	E	000015	A	66	45	5	4	000	NON	00				2016	5	2015		

Tomahawk Trl		0.32																													
AT RD/ST OFFSET MILES	TO ROAD NAME OFFSET MILES	LENGTH MILES (FEET)	OW L	SURFACE		MAINT	P	CURB		SHOULDER		MEDIAN		ADT		ROW		FC	RC	SC	O	U/A	NHS	H	AC	ALN		INV	PVT		SW
				Type	WD			YR	LT	RT	LT	RT	TYPE	WD	I	CNT	YR									I	W		H	V	
Mallard Dr	Running Bear Trl	0.09 (475)	N 2	40	20	1999	4	0	0	000	000			E	000015	E	66	45	5	4	000	NON	00				2016	4	2015		
Running Bear Trl	STH 58	0.23 (1214)	N 2	40	20	1999	4	0	0	000	000			E	000015	E	66	45	5	4	000	NON	00				2016	4	2015		

Trails' End Ct		0.10																													
AT RD/ST OFFSET MILES	TO ROAD NAME OFFSET MILES	LENGTH MILES (FEET)	OW L	SURFACE		MAINT	P	CURB		SHOULDER		MEDIAN		ADT		ROW		FC	RC	SC	O	U/A	NHS	H	AC	ALN		INV	PVT		SW
				Type	WD			YR	LT	RT	LT	RT	TYPE	WD	I	CNT	YR									I	W		H	V	
Lake Rd	Termini	0.08 (421)	N 2	70	20	2008				204	204			000000	A	66	45	5	4	000	NON	00				2016	4	2015			

Trophy Dr		0.70																													
AT RD/ST OFFSET MILES	TO ROAD NAME OFFSET MILES	LENGTH MILES (FEET)	OW L	SURFACE		MAINT	P	CURB		SHOULDER		MEDIAN		ADT		ROW		FC	RC	SC	O	U/A	NHS	H	AC	ALN		INV	PVT		SW
				Type	WD			YR	LT	RT	LT	RT	TYPE	WD	I	CNT	YR									I	W		H	V	
38th St	Forkhorn Ct	0.58 (3062)	N 2	65	20	2007	3	0	0	202	202	0	0	000000	A	66	45	5	4	000	NON	00				2016	8	2015			
Forkhorn Ct	38th St	0.12 (634)	N 2	65	20	2007	3	0	0	202	202	0	0	000000	A	66	45	5	4	000	NON	00				2016	8	2015			

Wally Way		0.08																													
AT RD/ST OFFSET MILES	TO ROAD NAME OFFSET MILES	LENGTH MILES (FEET)	OW L	SURFACE		MAINT	P	CURB		SHOULDER		MEDIAN		ADT		ROW		FC	RC	SC	O	U/A	NHS	H	AC	ALN		INV	PVT		SW
				Type	WD			YR	LT	RT	LT	RT	TYPE	WD	I	CNT	YR									I	W		H	V	
Haegenson Cir	Termini	0.08 (422)	N 2	35	16	1982	4	0	0	000	000			E	000005	A	66	45	5	4	000	NON	00			2016	4	2015			

STATE OF WISCONSIN
 DEPARTMENT OF TRANSPORTATION
 WISCONSIN INFORMATION SYSTEM FOR LOCAL ROADS
 Inventory Listing With Maintenance (R-20)
 1-1-2017 Certification

TOWN OF GERMANTOWN (012)

Certified Miles

Water St		0.43																												
AT RD/ST OFFSET MILES	TO ROAD NAME OFFSET MILES	LENGTH MILES (FEET)	OW' L	SURFACE		MAINT		CURB SHOULDER		MEDIAN		ADT		ROW		FC	RC	SC	O	U/A	NHS	H	AC	ALN		INV	PVT		SW	
				Type	WD	YR	Type	YR	P	LT	RT	LT	RT	Type	WD									I	CNT		YR	I		W
16th Ave	CTH G	0.43 (2270)	N 2 40	18	2008			3	0	0	202	202	0	0	E	000035	E	66	45	5	4	000	NON		00		2016	4	2015	

Waterstone Ln		0.48																											
AT RD/ST OFFSET MILES	TO ROAD NAME OFFSET MILES	LENGTH MILES (FEET)	OW' L	SURFACE		MAINT		CURB SHOULDER		MEDIAN		ADT		ROW		FC	RC	SC	O	U/A	NHS	H	AC	ALN		INV	PVT		SW
				Type	WD	YR	Type	YR	P	LT	RT	LT	RT	Type	WD									I	CNT		YR	I	
15th Ave	Wood Duck Ln	0.36 (1911)	N 2 70	24	2010									A	66	45	5	4	000	NON		00		00		2016	10	2015	
Wood Duck Ln	Termini	0.05 (283)	N 2 70	24	2010									A	66	45	5	4	000	NON		00		00		2016	10	2015	

Whistling Wings Dr		0.79																											
AT RD/ST OFFSET MILES	TO ROAD NAME OFFSET MILES	LENGTH MILES (FEET)	OW' L	SURFACE		MAINT		CURB SHOULDER		MEDIAN		ADT		ROW		FC	RC	SC	O	U/A	NHS	H	AC	ALN		INV	PVT		SW
				Type	WD	YR	Type	YR	P	LT	RT	LT	RT	Type	WD									I	CNT		YR	I	
STH 58	Raven Dr	0.11 (581)	N 2 40	20	1999			4	0	0	000	000		E	66	45	5	4	000	NON		00		00		2016	4	2015	
Raven Dr	Raven Dr	0.12 (634)	N 2 40	20	1999			4	0	0	000	000		E	66	45	5	4	000	NON		00		00		2016	4	2015	
Raven Dr	Mallard Dr	0.12 (634)	N 2 40	20	1999			4	0	0	000	000		E	66	45	5	4	000	NON		00		00		2016	4	2015	
Mallard Dr	Deer Path	0.44 (2323)	N 2 40	20	1999			4	0	0	000	000		E	66	45	5	4	000	NON		00		00		2016	4	2015	

White Oak Dr		0.16																											
AT RD/ST OFFSET MILES	TO ROAD NAME OFFSET MILES	LENGTH MILES (FEET)	OW' L	SURFACE		MAINT		CURB SHOULDER		MEDIAN		ADT		ROW		FC	RC	SC	O	U/A	NHS	H	AC	ALN		INV	PVT		SW
				Type	WD	YR	Type	YR	P	LT	RT	LT	RT	Type	WD									I	CNT		YR	I	
22nd Ave	Termini	0.16 (845)	N 2 70	20	2004			4	0	0	203	203	0	0	A	66	45	5	4	000	NON		00		2016	7	2015		

Windcrest Ct		0.13																											
AT RD/ST OFFSET MILES	TO ROAD NAME OFFSET MILES	LENGTH MILES (FEET)	OW' L	SURFACE		MAINT		CURB SHOULDER		MEDIAN		ADT		ROW		FC	RC	SC	O	U/A	NHS	H	AC	ALN		INV	PVT		SW
				Type	WD	YR	Type	YR	P	LT	RT	LT	RT	Type	WD									I	CNT		YR	I	
Bailey's Blvd	16th Ave	0.13 (695)	N 2 70	20	2008									A	66	45	5	4	000	NON		00		00		2016	10	2015	

STATE OF WISCONSIN
 DEPARTMENT OF TRANSPORTATION
 WISCONSIN INFORMATION SYSTEM FOR LOCAL ROADS
 Inventory Listing With Maintenance (R-20)
 1-1-2017 Certification

TOWN OF GERMANTOWN (012)

Certified Miles

Windover Ct		0.09																													
AT RD/ST OFFSET MILES	TO ROAD NAME OFFSET MILES	LENGTH MILES (FEET)	OW' L	SURFACE		MAINT		CURB		SHOULDER		MEDIAN		ADT		ROW		FC	RC	SC	O	U/A	NHS	H	AC	ALN		INV	PVT		SW
				Type	WD	YR	Type	YR	P	LT	RT	LT	RT	TYPE	WD	I	CNT									YR	I		W	H	
	Termini	0.08 (434)	N 2	70	20	2008					204	204			000000		A 66	45	5		4	000	NON		00		2016	10	2015		

Wood Duck Ln		0.05																													
AT RD/ST OFFSET MILES	TO ROAD NAME OFFSET MILES	LENGTH MILES (FEET)	OW' L	SURFACE		MAINT		CURB		SHOULDER		MEDIAN		ADT		ROW		FC	RC	SC	O	U/A	NHS	H	AC	ALN		INV	PVT		SW
				Type	WD	YR	Type	YR	P	LT	RT	LT	RT	TYPE	WD	I	CNT									YR	I		W	H	
	Waterstone Ln	0.06 (296)	N 2	70	24	2008					00	00			000000		A 66	45	5		4	000	NON		00		2016	10	2015		

Woodland Dr		0.14																													
AT RD/ST OFFSET MILES	TO ROAD NAME OFFSET MILES	LENGTH MILES (FEET)	OW' L	SURFACE		MAINT		CURB		SHOULDER		MEDIAN		ADT		ROW		FC	RC	SC	O	U/A	NHS	H	AC	ALN		INV	PVT		SW
				Type	WD	YR	Type	YR	P	LT	RT	LT	RT	TYPE	WD	I	CNT									YR	I		W	H	
	Termini	0.14 (739)	N 2	55	16	2008			3	0	0	203	203		E 000050		E 66	45	5		4	000	NON		00		2016	4	2015		

Woodland Trl		0.49																													
AT RD/ST OFFSET MILES	TO ROAD NAME OFFSET MILES	LENGTH MILES (FEET)	OW' L	SURFACE		MAINT		CURB		SHOULDER		MEDIAN		ADT		ROW		FC	RC	SC	O	U/A	NHS	H	AC	ALN		INV	PVT		SW
				Type	WD	YR	Type	YR	P	LT	RT	LT	RT	TYPE	WD	I	CNT									YR	I		W	H	
	Poplar Ln	0.13 (686)	N 2	40	22	2005			3	0	0	000	000		E 000015		A 66	45	5		4	000	NON		00		2016	4	2015		
	Poplar Ln	0.27 (1426)	N 2	40	22	2005			3	0	0	000	000		E 000015		A 66	45	5		4	000	NON		00		2016	4	2015		
	Poplar Ln	0.09 (475)	N 2	40	22	2005			3	0	0	000	000		E 000015		A 66	45	5		4	000	NON		00		2016	4	2015		

Woodside Ave		0.24																													
AT RD/ST OFFSET MILES	TO ROAD NAME OFFSET MILES	LENGTH MILES (FEET)	OW' L	SURFACE		MAINT		CURB		SHOULDER		MEDIAN		ADT		ROW		FC	RC	SC	O	U/A	NHS	H	AC	ALN		INV	PVT		SW
				Type	WD	YR	Type	YR	P	LT	RT	LT	RT	TYPE	WD	I	CNT									YR	I		W	H	
	Termini	0.07 (370)	N 2	50	20	2007			3	0	0	202	202		E 000015		E 60	45	5		4	000	NON		00		2016	4	2015		
	Termini	0.17 (898)	N 2	40	20	1999			4	0	0	102	102		E 000015		E 60	45	5		4	000	NON		00		2016	4	2015		

APPENDIX B – PASER Rating System

PASER Asphalt Surface Rating System

Surface Rating	Visible Distress*	General condition/ Treatment measures
10 <i>Excellent</i>	None.	New construction.
9 <i>Excellent</i>	None.	Recent overlay, like new..
8 <i>Very Good</i>	No longitudinal cracks except reflection of paving joints. Occasional transverse cracks, widely spaced (40" or greater). All cracks sealed or tight (open ¼" or less).	Recent sealcoat or new road mix. Little or no maintenance required.
7 <i>Good</i>	Very slight or no ravelling, surface shows some traffic wear. Longitudinal cracks (open ¼") due to reflection or paving joints. Transverse cracks (open ¼") spaced 10 feet or more apart, little or slight crack ravelling. No patching or very few patches in excellent condition.	First signs of aging. Maintain with routine crack filling.
6 <i>Good</i>	Slight raveling (loss of fines) and traffic wear. Longitudinal cracks (open ¼" – ½") due to reflection and paving joints. Transverse cracking (open ¼" to ½") some paced less than 10 feet. First sign of block cracking. Slight to moderate flushing or polishing. Occasional patching in good condition.	Show signs of aging, sound structural condition. Could extend life with sealcoat.

*Note: Individual roadways may not have all of the types of distress listed for any particular rating. Each road may have only one or two types of distress.

PASER Asphalt Surface Rating System (continued)

Surface Rating	Visible Distress*	General condition/ Treatment measures
5 <i>Fair</i>	<p>Moderate to severe raveling (loss of fine and coarse aggregate).</p> <p>Longitudinal and transverse cracks (open ½") show first signs of slight raveling and secondary cracks. First signs of longitudinal cracks near pavement edge.</p> <p>Block cracking up to 50% of surface.</p> <p>Extensive to severe flushing or polishing.</p> <p>Some patching or edge wedging in good condition.</p>	<p>Surface aging, sound structural condition. Needs sealcoat or nonstructural overlay.</p>
4 <i>Fair</i>	<p>Severe surface raveling.</p> <p>Multiple longitudinal and transverse cracking with slight raveling.</p> <p>Longitudinal cracking in wheel path.</p> <p>Block cracking (over 50%) of surface).</p> <p>Patching in fair condition.</p> <p>Slight rutting or distortions (1/2" deep or less).</p>	<p>Significant aging and first signs of need for strengthening. Would benefit from recycling or overlay.</p>
3 <i>Poor</i>	<p>Closely spaced longitudinal and transverse cracks often showing raveling and crack erosion.</p> <p>Severe block cracking.</p> <p>Some alligator cracking (less than 25% of surface).</p> <p>Patches in fair to poor condition.</p> <p>Moderate rutting or distortion (1" or 2" deep).</p> <p>Occasional potholes.</p>	<p>Needs patching and major overlay or complete recycling.</p>
2 <i>Very Poor</i>	<p>Alligator cracking (over 25% of surface).</p> <p>Severe distortions (over 2" deep).</p> <p>Extensive patching in poor condition.</p> <p>Potholes.</p>	<p>Severe deterioration. Needs reconstruction with extensive base repair.</p>
1 <i>Failed</i>	<p>Severe distress with extensive loss of surface integrity.</p>	<p>Failed. Needs total reconstruction.</p>

*Note: Individual roadways may not have all of the types of distress listed for any particular rating. Each road may have only one or two types of distress.

PASER Gravel Surface Rating System		
Surface Rating	Visible Distress*	General condition/ Treatment measures
5 (10) <i>Excellent</i>	No distress. Dust controlled. Excellent surface condition and ride.	New construction – or total reconstruction. Excellent drainage. Little or no maintenance required.
4 (8) <i>Good</i>	Dust under dry conditions. Moderate loose aggregate. Slight washboarding.	Recently regraded. Good crown and drainage throughout. Adequate gravel for traffic. Routine maintenance may be needed.
3 (6) <i>Fair</i>	Good crown (3"-6") Ditches present on more than 50% of roadway. Gravel layer is mostly adequate but additional aggregate may be needed at a few locations to help correct washboarding or isolated potholes and ruts. Some culvert cleaning needed. Moderate washboarding (1"-2" deep), over 10%-20% of the area. Moderate dust, partial obstruction of vision. None or slight rutting (less than 1" deep). An occasional small pothole (less than 2" deep). Some loose aggregate (2" deep).	Shows traffic effects. Regrading (reworking) necessary to maintain. Needs some ditch improvement and culvert maintenance. Some areas may need additional gravel.

*Note: Individual roadways may not have all of the types of distress listed for any particular rating. Each road may have only one or two types of distress.

PASER Gravel Surface Rating System (continued)

Surface Rating	Visible Distress*	General condition/ Treatment measures
2 (4) <i>Poor</i>	<p>Little or no roadway crown (less than 3").</p> <p>Adequate ditches on less than 50% of roadway. Portions of the ditches may be filled, overgrown and/or show erosion.</p> <p>Some areas (25%) with little or no aggregate.</p> <p>Culverts partially full of debris.</p> <p>Moderate to severe washboarding (over 3" deep) over 25% of area.</p> <p>Moderate rutting (1"- 3"), over 10% - 25% of area.</p> <p>Moderate potholes (2" - 4"), over 10% - 25% of area.</p> <p>Severe loose aggregate (over 4").</p>	<p>Travel at slow speeds (less than 25 mph) is required.</p> <p>Needs additional new aggregate.</p> <p>Major ditch construction and culvert maintenance also required.</p>
1 (2) <i>Failed</i>	<p>No roadway crown or road is bowl shaped with extensive ponding.</p> <p>Little if any ditching.</p> <p>Filled or damaged culverts.</p> <p>Severe rutting (over 3" deep), over 25% of the area.</p> <p>Severe potholes (over 4" deep), over 25% of area.</p> <p>Many areas (over 25%) with little or no aggregate.</p>	<p>Travel is difficult and road may be closed at times.</p> <p>Needs complete rebuilding and/or new culverts.</p>

*Note: Individual roadways may not have all of the types of distress listed for any particular rating. Each road may have only one or two types of distress.

Source: Wisconsin Transportation Information Center.

APPENDIX C – Town Road Map

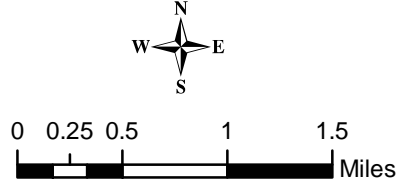
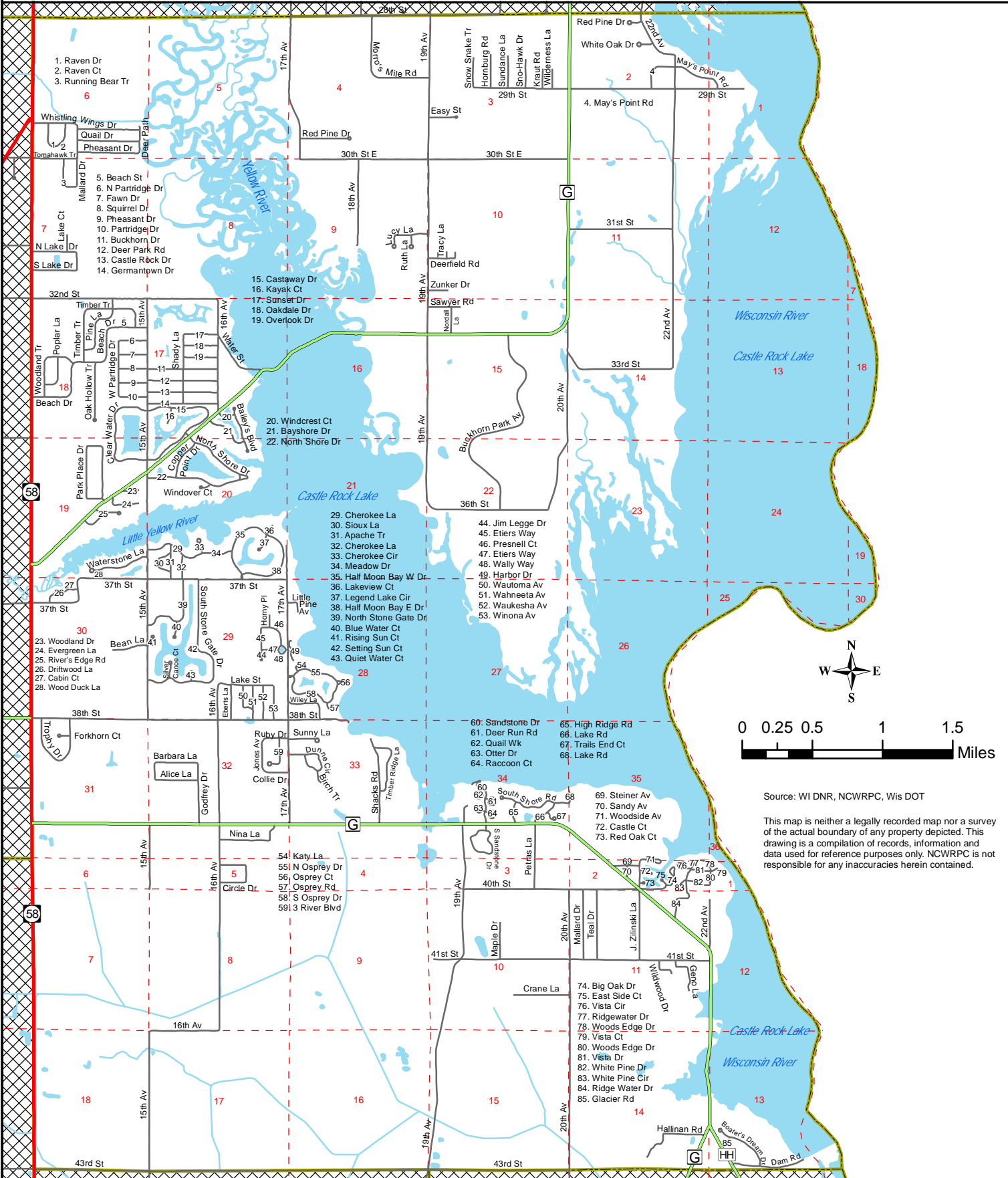

Source: WI DNR, NCRWPC, Wis DOT

This map is neither a legally recorded map nor a survey of the actual boundary of any property depicted. This drawing is a compilation of records, information and data used for reference purposes only. NCRWPC is not responsible for any inaccuracies herein contained.

- Minor Civil Divisions
- Section Lines
- State Highways
- County Highways
- Local Roads
- Water

North Central Wisconsin Regional Planning Commission

210 McClellan St., Suite 210, Wausau, WI 54403
 715-849-5510 - staff@ncwrpc.org - www.ncwrpc.org

APPENDIX D – Additional Projects Outside Budget Allocation

TOWN OF GERMANTOWN
Additional Project Recommendations Outside Current Budget Allocation

All measurements in feet.

On Route	At Route	At	Offset	Toward	Route	To	Offset	Length	Width	Surf. Type	Pvmt Rtg		Action	Cost	Priority Score
											Yr	Yr			
38th St	STH 58 / CTH A		0	15th Ave		4435	4435	20	70	6		6	Reconstruct/Widen	TBD	39.92
38th St	15th Ave		0	17th Ave		5333	5333	20	70	7		7	Reconstruct/Widen	TBD	49.9
38th St	17th Ave		0	Termini		2059	2059	20	70	7		7	Crack Sealing	\$1,875	49.9
Jim Legge Dr	Etiers Way		0	Termini		422	422	20	50	3		3	9 Mill and Overlay	\$6,639	24.95
Trails' End Ct	Lake Rd		0	Termini		421	421	20	70	4		4	9 Resurfacing	\$6,086	28.51
Woodland Dr	CTH G		0	Termini		739	739	16	55	4		4	9 Resurfacing	\$8,429	28.51
Woodside Ave	Evergreen St		0	Termini		370	370	20	50	4		4	9 Resurfacing	\$4,766	28.51
Oak Hollow Trl	Beach Dr		0	Termini		2270	2270	22	45	4		4	9 Resurfacing	\$33,610	28.51
Apache Ln	Cherokee Ln		0	37th St E		1320	1320	21	40	4		4	4 Sealcoat	\$2,786	39.92
Godfrey Dr	CTH G		0	Barbara Ln		2324	2324	18	40	4		4	4 Sealcoat	\$4,430	39.92
Water St	16th Ave		0	CTH G		2270	2270	18	40	4		4	4 Sealcoat	\$4,156	39.92
Cherokee Ln	37th St E		0	15th Ave		2376	2376	22	40	3		3	4 Sealcoat	\$4,878	39.92
Jones Ave	Ruby Dr		0	Collie Dr		1319	1319	22	40	3		3	4 Sealcoat	\$3,106	39.92
Presnell Ct	Termini		0	Etiers Way		370	370	22	40	3		3	4 Sealcoat	\$759	39.92
Sullivan's Ln	Barbara Ln		0	Alice Ln		634	634	18	40	3		3	4 Sealcoat	\$1,208	39.92
Half Moon Bay Dr E	Half Moon Bay Dr W / Legend Lake Cir		0	Half Moon Bay Dr W		3168	3168	24	55	8		8	7 Crack Sealing	\$3,463	49.9
Half Moon Bay Dr W	Half Moon Bay Dr E / Legend Lake Cir		0	37th St E		3062	3062	24	55	8		8	7 Crack Sealing	\$3,347	49.9
May's Point Rd	29th St E		0	29th St E		3538	3538	20	70	8		8	7 Crack Sealing	\$3,223	49.9
Trophy Dr	38th St		0	38th St		3696	3696	20	65	8		8	7 Crack Sealing	\$3,367	49.9
16th Ave	CTH G		3274	15th Ave / 43rd St		10349	7075	18	35	3		3	4 Add Stone+Regrade	\$19,542	28.51
18th St	30th St E		0	Termini		3221	3221	16	35	1		1	Add Stone+Regrade	\$17,277	19.96
Bean Ln	Termini		0	15th Ave/Rising Sun Ct		1320	1320	8	35	3		3	4 Add Stone+Regrade	\$1,442	28.51